

6715-04 Level 2 Diploma in Craft Masonry

June 2014 Version 1.0

PRACTICAL TASK MANUAL

Contents

| | |
|--|-----------|
| Candidate details | 2 |
| Unit assessment overview | 3 |
| Practical task completion record | 3 |
| Instructions to candidates | 5 |
| Unit 205 Interpreting working drawings to set out masonry structures | 6 |
| Task 1 Set out a masonry structure | 6 |
| Unit 246 Build solid and cavity walls to form craft masonry structures | 14 |
| Task 1 Build a one brick thick wall with pier and stone panels | 14 |
| Task 2 Erect a cavity wall | 26 |
| Unit 247 Internal and external finishes for craft masonry structures | 38 |
| Task 1 Produce internal finishes on a solid and a plasterboard background | 38 |
| Task 2 Produce an external finish on a solid background | 49 |
| Unit 248 Install pitched roof systems for small-scale building projects | 60 |
| Task 1 Install two roof systems to a small pitched roof | 60 |

Candidate details



This *Practical Task Manual* is a record of your achievement in practical assessments. You must keep it in good condition and it must be stored in a safe place by your Assessor.

Please fill in all of your details before you carry out any assessments.

Candidate Details

| | | | |
|---------|--|-------------|--|
| Surname | | Forename(s) | |
|---------|--|-------------|--|

| | |
|--------------------------------|--|
| City & Guilds enrolment number | |
|--------------------------------|--|

Centre Details

| | | | |
|------|--|-----------|--|
| Name | | Centre No | |
|------|--|-----------|--|

I understand the requirements of the qualification and that all the work towards the assessments must be my own.

| | |
|----------------------------|--|
| Candidate signature | |
|----------------------------|--|

| | | | |
|--|--|--------|--|
| Assessor name (please print) | | Signed | |
|--|--|--------|--|

| | |
|------|--|
| Date | |
|------|--|

Unit assessment overview

Practical task completion record

To be completed by Assessor:

For each task, the points for each grade are
 Pass = 1, Merit = 2, and Distinction = 3 points.

| Conversion chart | |
|------------------|---------------|
| Average | Overall Grade |
| 1 – 1.5 | Pass |
| 1.6 – 2.5 | Merit |
| 2.6 – 3 | Distinction |

†All tasks must be passed for the unit to be achieved.

Unit 205 Interpreting working drawings to set out masonry structures

| Task | Grade for task† |
|------------------------------------|----------------------|
| 1. Set out a masonry structure | P / M / D / X |
| Internally marked questions | P / X |
| Assessor name, signature and date: | Overall grade |
| | |

Unit 246 Build solid and cavity walls to form craft masonry structures

| Task | Grade for task† | Points (graded tasks) |
|---|-----------------|-----------------------|
| 1. Build a one brick thick wall with pier and stone panels | P / M / D / X | |
| 2. Erect a cavity wall | P / M / D / X | |
| Internally marked questions | P / X | |
| Total | | |
| Divide total points from graded tasks by number of graded tasks | | ÷ 2 |
| Average = | | |
| Overall grade (see conversion chart) | | |

Assessor name, signature and date:

Unit 247 Internal and external finishes for craft masonry structures

| Task | Grade for task [†] | Points (graded tasks) |
|---|---|--------------------------|
| 1. Produce internal finishes on a solid and a plasterboard background | P / M / D / X | |
| 2. Produce an external finish on a solid background | P / M / D / X | |
| Internally marked questions | P / X | |
| Total | | |
| Assessor name, signature and date: | Divide total points from graded tasks by number of graded tasks | ÷ 2 |
| | Average = | |
| | Overall grade (see conversion chart) | |

Unit 248 Install pitched roof systems for small-scale building projects

| Task | Grade for task [†] |
|---|-----------------------------|
| 1. Install two roof systems to a small pitched roof | P / M / D / X |
| Internally marked questions | P / X |
| Assessor name, signature and date: | Overall grade |

Instructions to candidates

About this document

This *Practical Task Manual* contains all of the practical assessment for the 6715-04 Level 2 Diploma in Craft Masonry.

Practical tasks

These tasks let you show your practical skills and are graded pass, merit or distinction. These tasks will be assessed by your assessor watching how you carry out the tasks and checking your final pieces of work.

Before you carry out the task you will be told how it will be assessed and you should read the observation checklist at the end of each task so you know what you need to do to get each grade.

You can ask your assessor for help in understanding the task instructions, but all of the work must be your own.

Health and safety

You must use safe working practices at all times.

You are responsible for your own safety and the safety of others. If you behave in an unsafe way, you will be stopped and given a warning. If you do not meet all of the Health and Safety requirements, the assessment will be stopped. Your assessor will not be able to let you try the task again until they are sure you can work safely.

Time considerations

The amount of time each task should take you to complete is stated in this document. This is for guidance, so you can plan your work, and it also used to help determine your grade. If you exceed the stated task time by specified amounts, you may not be able to achieve a merit or distinction grade (please refer to the individual tasks within this document for more details). If you have a good reason for needing more time you must explain this to your assessor as soon as possible so they can decide whether you can have more time.

Security

Where an assignment is taken over more than one session, all documentation, paperwork and work products must be labelled carefully with your name and kept securely at the centre. Your assessor will give you directions about how to leave your work.

Opportunities to repeat tasks

The tasks are 'end tests' so you will only be asked to take the assessment when you have had the chance to do all of the learning and practice you need. You will be able to try the whole task again if you do not pass, but you will not be able to take the assessment again just to try to get a better grade.

Feedback

As well as telling you the result for the task, your assessor will give you feedback. They will give you a feedback sheet with details of what you could do to improve, and also what you did well. This will help you to prepare for other assessments or to retake the assessment if you need to.

Unit 205 Interpreting working drawings to set out masonry structures

Task 1 Set out a masonry structure

Task coversheet

| | |
|--------------------------|--|
| Expected time | 6 hours |
| Task instructions | <p>In this task you will be required to:</p> <ul style="list-style-type: none">• read the drawing and specification• complete a resource checklist (including a walk over survey)• complete a method statement• set out and check measurements• keep a clean work area• work safely at all times. |

Unit 205 Interpreting working drawings to set out masonry structures

Task 1 Set out a masonry structure

Drawings and specifications

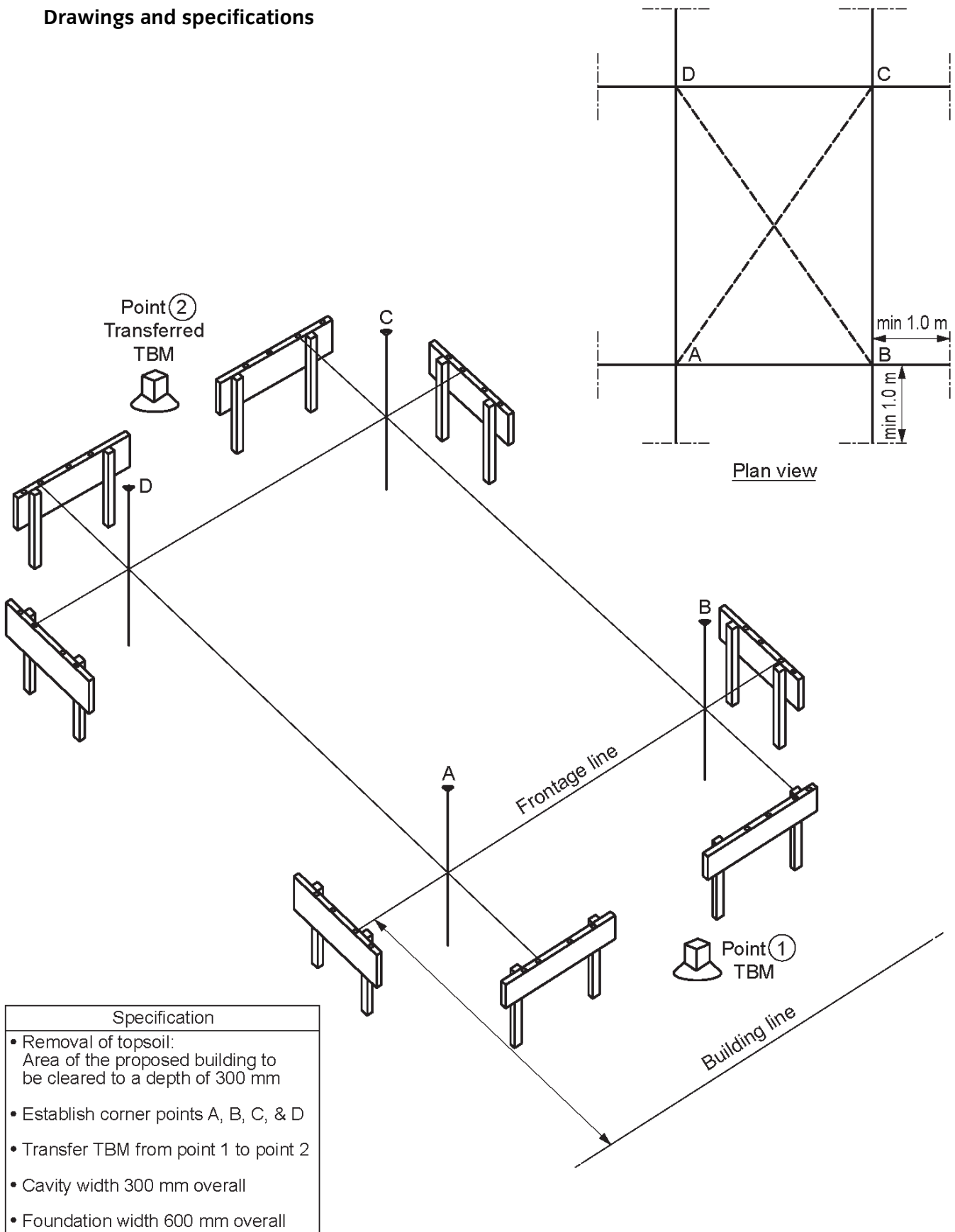

| Specification |
|---|
| • Removal of topsoil: Area of the proposed building to be cleared to a depth of 300 mm |
| • Establish corner points A, B, C, & D |
| • Transfer TBM from point 1 to point 2 |
| • Cavity width 300 mm overall |
| • Foundation width 600 mm overall |

| Materials | Quantity | Condition |
|------------------|-----------------|---|
| <i>eg blocks</i> | <i>20</i> | <i>Clean, dry and free from defects</i> |
| | | |
| | | |
| | | |
| | | |
| | | |
| | | |
| | | |

| Personal Protective Equipment (PPE) | Quantity | Condition |
|--|-----------------|--|
| <i>eg safety harness</i> | <i>1</i> | <i>Free from defects, correct size</i> |
| | | |
| | | |
| | | |
| | | |
| | | |
| | | |
| | | |
| | | |

| Volume of topsoil to be removed (show calculations) |
|--|
| |

Unit 205 Interpreting working drawings to set out masonry structures

Task 1 Set out a masonry structure

Method Statement

| | | |
|---|-------|--------------|
| Department/Location | | |
| Risk Assessment No. | | |
| Description of the task/Activity | | |
| Personnel Involved | Names | Roles/Trades |
| Key Plant & Tools | | |
| Key Materials | | |
| Other Essential Equipment (ie access platforms/winches/ladders, etc) | | |
| Sequence of Operations (include sketches if required) | | |
| Other information & Comments | | |

Unit 205 Interpreting working drawings to set out masonry structures

Task 1 Set out a masonry structure

Observation checklist

| AC | The candidate has | Pass | Merit | Distinction |
|---------------------|---|---------------------------------------|---------------------------------------|--------------------------------------|
| 2.1, 2.3 | read drawing and specifications, and confirmed understanding of the task | <input type="checkbox"/> | | |
| 2.4, 2.5 | correctly answered the oral question on discrepancies | <input type="checkbox"/> | | |
| 4.2, 4.3 | performed a walk-over survey to establish site conditions and recorded findings on the resource checklist | <input type="checkbox"/> | | |
| 2.6 | completed the method statement | <input type="checkbox"/> | | |
| 4.1, 6.1 | completed the resource checklist | <input type="checkbox"/> | | |
| 4.4 | correctly calculated the volume of topsoil to be removed and recorded answer on the resource checklist | <input type="checkbox"/> | | |
| 2.2, 6.3, 8.2 | established positions of ranging lines from working drawings | <input type="checkbox"/> +/- 12 mm | <input type="checkbox"/> +/- 8 mm | <input type="checkbox"/> +/- 4 mm |
| 8.3 | ensured frontage line is parallel to building line | <input type="checkbox"/> +/- 12 mm | <input type="checkbox"/> +/- 8 mm | <input type="checkbox"/> +/- 4 mm |
| 6.2, 8.4, 8.7 | correctly set out the linear measurement between point A and point B | <input type="checkbox"/> +/- 12 mm | <input type="checkbox"/> +/- 8 mm | <input type="checkbox"/> +/- 4 mm |
| | correctly set out the linear measurement between point B and point C | <input type="checkbox"/> +/- 12 mm | <input type="checkbox"/> +/- 8 mm | <input type="checkbox"/> +/- 4 mm |
| | correctly set out the linear measurement between point C and point D | <input type="checkbox"/> +/- 12 mm | <input type="checkbox"/> +/- 8 mm | <input type="checkbox"/> +/- 4 mm |
| | correctly set out the linear measurement between point D and point A | <input type="checkbox"/> +/- 12 mm | <input type="checkbox"/> +/- 8 mm | <input type="checkbox"/> +/- 4 mm |
| | established equal diagonals | <input type="checkbox"/> +/- 24 mm | <input type="checkbox"/> +/- 16 mm | <input type="checkbox"/> +/- 8 mm |
| 8.1, 8.5 | positioned profiles securely and as indicated on the drawing | <input type="checkbox"/> | | |
| | located positions of building and marked walling and trench positions onto profiles | <input type="checkbox"/> +/- 6 mm | <input type="checkbox"/> +/- 4 mm | <input type="checkbox"/> +/- 2 mm |
| 6.4, 8.6 | transferred datum height from point 1 to point 2 | <input type="checkbox"/> +/- 10 mm | <input type="checkbox"/> +/- 6 mm | <input type="checkbox"/> +/- 3 mm |
| 8.8 | used correct access equipment if required, or correctly answered oral question on access equipment | <input type="checkbox"/> | | |

| AC | The candidate has | Pass | Merit | Distinction |
|-----------------------------|---|--------------------------|-------|-------------|
| 2.7, 4.5, 6.5, 8.9 | followed current environmental and relevant health and safety legislation | <input type="checkbox"/> | | |
| | used tools, equipment and materials in a safe manner | <input type="checkbox"/> | | |
| | used and maintained PPE as appropriate | <input type="checkbox"/> | | |
| | maintained a clean and safe working area | <input type="checkbox"/> | | |
| | cleaned and returned all tools and equipment once the task is complete. | <input type="checkbox"/> | | |

| Task grading rules | Task grade: |
|---|-------------|
| <p>To achieve a pass:</p> <ul style="list-style-type: none"> • all pass criteria must be met. | |
| <p>To achieve a merit:</p> <ul style="list-style-type: none"> • a minimum of 6/9 merit criteria must be met, and; • all pass criteria must be met, and; • the candidate must not exceed the expected task time by more than 50%. | |
| <p>To achieve a distinction:</p> <ul style="list-style-type: none"> • a minimum of 6/9 distinction criteria must be met, and; • the remaining graded criteria at merit level must be met, and; • all pass criteria must be met, and; • the candidate must not exceed the expected task time by more than 25%. | |
| Assessor Name | |
| Assessor Signature | |
| Date | |

Unit 205 Interpreting working drawings to set out masonry structures

Task 1 Set out a masonry structure

Unit feedback and action planning form

| | |
|-----------------------|--|
| Unit title | |
| Candidate name | |

| Unit feedback | | |
|---------------|-------------|------------------|
| | | |
| Action plan | Target date | Achievement date |
| | | |

This unit feedback and action plan has been agreed by:

| Role | Print name | Signed | Date |
|-------------|------------|--------|------|
| Candidate | | | |
| Assessor | | | |
| Internal QA | | | |

Unit 246 Build solid and cavity walls to form craft masonry structures

Task 1 Build a one brick thick wall with pier and stone panels

Task coversheet

| | |
|--------------------------|---|
| Expected time | 10 hours |
| Task instructions | <p>In this task you will be required to:</p> <ul style="list-style-type: none">• read the drawing and specification• complete a method statement and risk assessment• complete a resource checklist• set out brickwork• position mortar boards, bricks and stone• build a solid wall and stone panels with pier• keep a clean work area• work safely at all times. |

Unit 246 Build solid and cavity walls to form craft masonry structures

Task 1 Build a one brick thick wall with pier and stone panels

Drawings

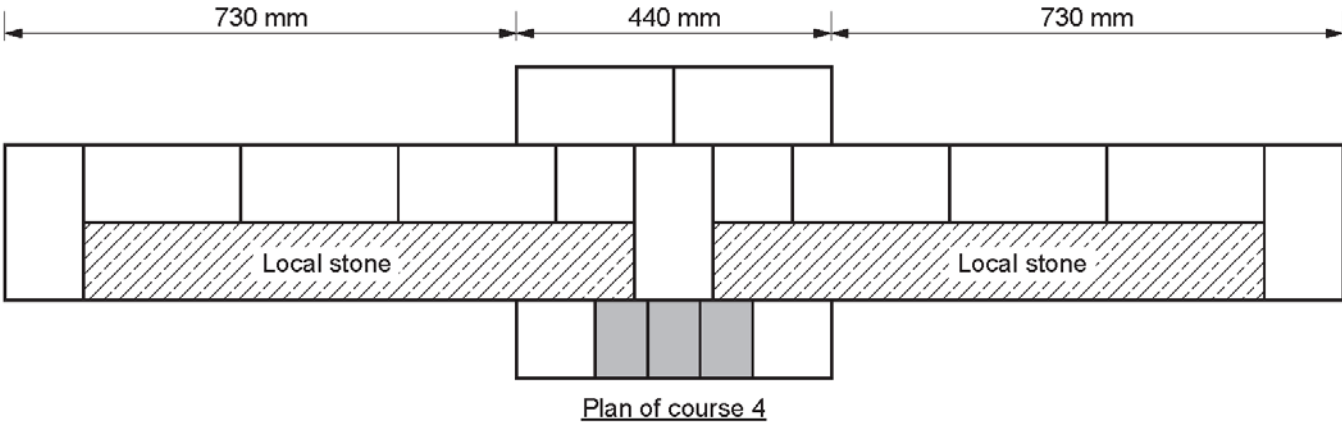
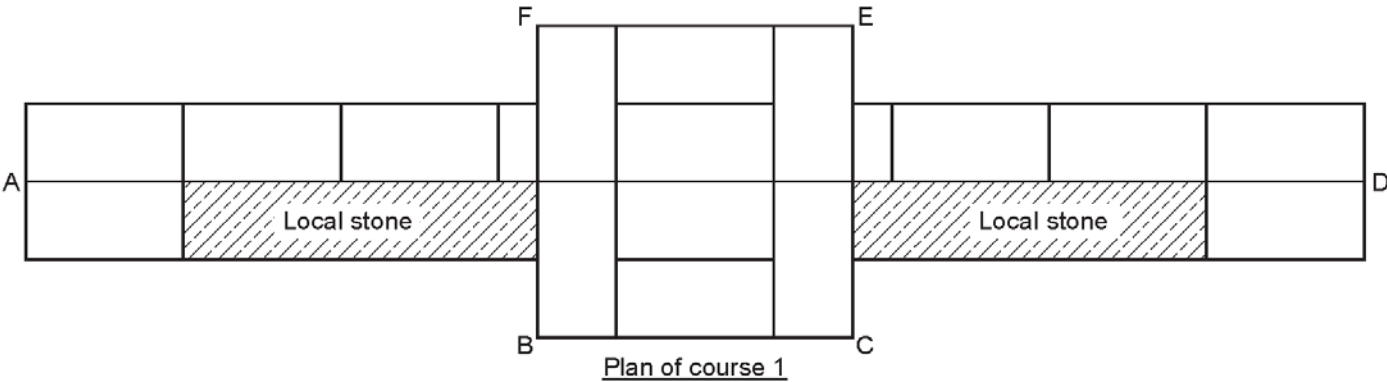
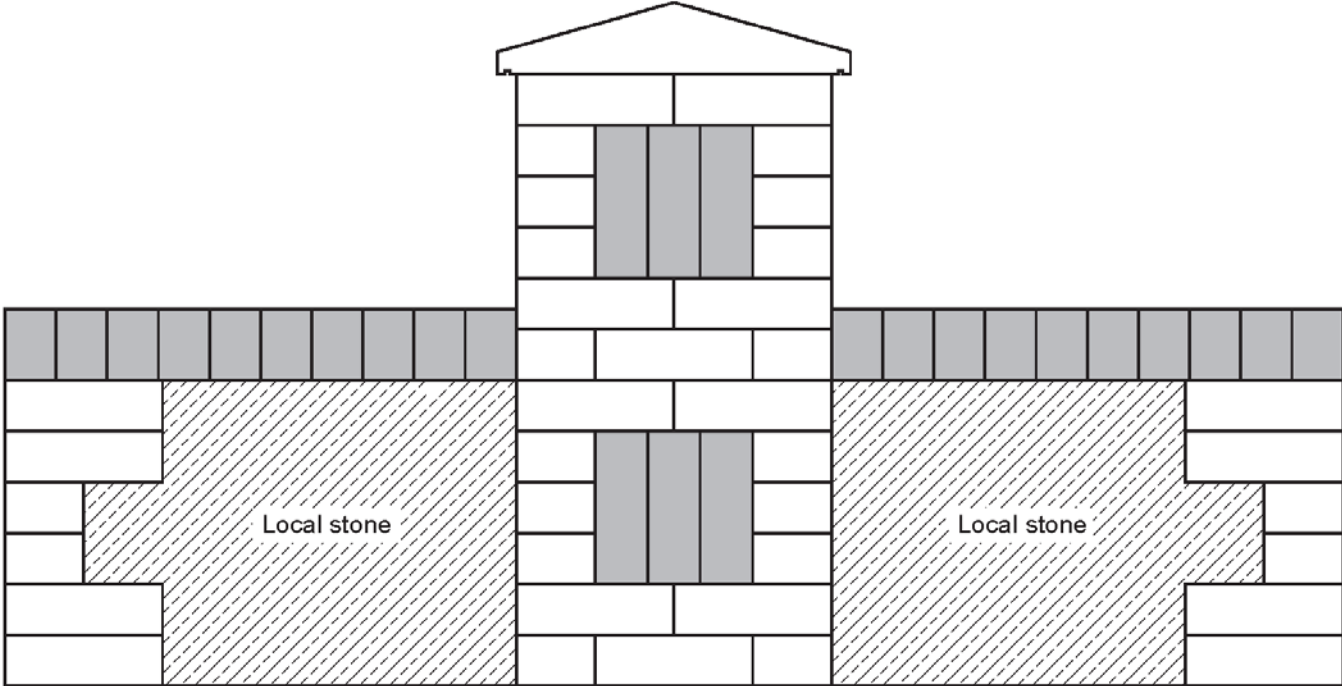

Unit 246 Build solid and cavity walls to form craft masonry structures

Task 1 Build a one brick thick wall with pier and stone panels

Specifications

- Soldiers and brick on edge to use contrasting bricks
- Joint finish:
 - All brick faces half round (including brick on edge)
 - Isolated pier to be jointed on all four faces
 - Rear of wall to be finished flush from the trowel
 - Local stone joints to assessor's discretion
- Gauge:
 - 4 course to 300 mm
- Pier capping to assessor's discretion

Unit 246 Build solid and cavity walls to form craft masonry structures

Task 1 Build a one brick thick wall with pier and stone panels

Method statement

| | | |
|---|-------|--------------|
| Department/Location | | |
| Risk Assessment No. | | |
| Description of the task/Activity | | |
| Personnel Involved | Names | Roles/Trades |
| Key Plant & Tools | | |
| Key Materials | | |
| Other Essential Equipment (ie access platforms/winches/ladders, etc) | | |
| Sequence of Operations (include sketches if required) | | |
| Other information & Comments | | |

Unit 246 Build solid and cavity walls to form craft masonry structures

Task 1 Build a one brick thick wall with pier and stone panels

Risk assessment

| Candidate Name | | SEVERITY (S): Degree of harm which may be caused (including numbers affected) 1 = Minor Injury 2 = Major Injury 3 = Fatality | | LIKELIHOOD (L): Probability that event will occur 1 = Remote 2 = Possible 3 = Likely | | RISK RATING (RR): Severity x Likelihood 1-2 = Low 3-4 = Medium 6-9 = High | |
|----------------|---|---|-------------------|--|------------|---|--|
| Date | Activity | Hazard | Existing Controls | S (1-3) | L (1-3) | RR (S x L) | Actions needed |
| 18 July 2013 | Apply materials and fix tiles to surfaces | Chemical based adhesives | PPE | 1 | 2 | 2 | Implement sign off sheet to ensure PPE is worn |
| | | | | | | | |

| | | Likelihood | | |
|----------|---|------------|----------|-------------|
| | | Unlikely | Possible | Very likely |
| Severity | 1 Slight / minor injuries / minor damage | 1 | 2 | 3 |
| | 2 Medium injuries / significant damage | 2 | 4 | 6 |
| | 3 Major injury / extensive damage | 3 | 6 | 9 |

Likelihood

- 3 = Very likely
- 2 = Possible
- 1 = Unlikely

Severity

- 3 = Major injury / extensive damage
- 2 = Medium injury / significant damage
- 1 = Slight / minor damage

Key:

- 1 = Low risk, action should be taken to reduce the risk if reasonably practicable
- 2, 3, 4 = Medium risk, is a significant risk and would require an appropriate level of control measures.
- 6 & 9 = High risk, should not be undertaken without prior agreement.

Unit 246 Build solid and cavity walls to form craft masonry structures

Task 1 Build a one brick thick wall with pier and stone panels

Observation checklist

| AC | The candidate has | Pass | Merit | Distinction |
|---------------|---|--------------------------------------|--------------------------------------|--------------------------------------|
| 2.1 | read drawing and specification, and confirmed understanding of the task | <input type="checkbox"/> | | |
| 2.2 | completed the method statement | <input type="checkbox"/> | | |
| 2.3 | completed the risk assessment | <input type="checkbox"/> | | |
| 2.4, 2.5, 2.6 | completed the resource checklist | <input type="checkbox"/> | | |
| 4.1 | positioned mortar boards, bricks and stone | <input type="checkbox"/> | | |
| 4.3 | prepared and safely cut materials | <input type="checkbox"/> | | |
| 4.2 | gauged top of point A and transferred height to point D | <input type="checkbox"/> | | |
| | accurately set out length of wall | <input type="checkbox"/> +/- 8 mm | <input type="checkbox"/> +/- 6 mm | <input type="checkbox"/> +/- 4 mm |
| | accurately set out pier to square | <input type="checkbox"/> +/- 6 mm | <input type="checkbox"/> +/- 4 mm | <input type="checkbox"/> +/- 2 mm |
| | accurately set out pier to size | <input type="checkbox"/> +/- 6 mm | <input type="checkbox"/> +/- 4 mm | <input type="checkbox"/> +/- 2 mm |
| 4.4 | maintained overall gauge to pier from top of first course | <input type="checkbox"/> +/- 6 mm | <input type="checkbox"/> +/- 4 mm | <input type="checkbox"/> +/- 2 mm |
| | built brickwork plumb (area A – 3 points) | <input type="checkbox"/> +/- 6 mm | <input type="checkbox"/> +/- 4 mm | <input type="checkbox"/> +/- 2 mm |
| | built brickwork plumb (area B – 2 points) | <input type="checkbox"/> +/- 6 mm | <input type="checkbox"/> +/- 4 mm | <input type="checkbox"/> +/- 2 mm |
| | built brickwork plumb (area C – 2 points) | <input type="checkbox"/> +/- 6 mm | <input type="checkbox"/> +/- 4 mm | <input type="checkbox"/> +/- 2 mm |
| | built brickwork plumb (area D – 3 points) | <input type="checkbox"/> +/- 6 mm | <input type="checkbox"/> +/- 4 mm | <input type="checkbox"/> +/- 2 mm |
| | built brickwork plumb (area E – 2 points) | <input type="checkbox"/> +/- 6 mm | <input type="checkbox"/> +/- 4 mm | <input type="checkbox"/> +/- 2 mm |
| | built brickwork plumb (area F – 2 points) | <input type="checkbox"/> +/- 6 mm | <input type="checkbox"/> +/- 4 mm | <input type="checkbox"/> +/- 2 mm |
| | maintained face planes to stone panels | <input type="checkbox"/> +/- 8 mm | <input type="checkbox"/> +/- 6 mm | <input type="checkbox"/> +/- 4 mm |
| | ensured pier is bonded to solid wall | <input type="checkbox"/> | | |
| 4.5 | ensured decorative soldiers to the face of the pier are plumb and flush | <input type="checkbox"/> | | |

| AC | The candidate has | Pass | Merit | Distinction |
|-------------------------------------|---|--------------------------------------|--------------------------------------|--------------------------------------|
| | maintained overall level of brick on edge | <input type="checkbox"/> +/- 6 mm | <input type="checkbox"/> +/- 4 mm | <input type="checkbox"/> +/- 2 mm |
| | ensured pier cap is level with equal projections | <input type="checkbox"/> | | |
| 4.6 | produced joint finishes to brickwork (half round) with no smudging | <input type="checkbox"/> | | |
| | produced appropriate joint finishes (continuous and full) to stonework | <input type="checkbox"/> | | |
| 2.4, 2.5, 2.7, 4.7, 4.8 | followed current environmental and relevant health and safety regulations | <input type="checkbox"/> | | |
| | used tools, equipment and materials in a safe manner | <input type="checkbox"/> | | |
| | used and maintained PPE as appropriate | <input type="checkbox"/> | | |
| | maintained a clean and safe working area | <input type="checkbox"/> | | |
| | cleaned and returned all tools and equipment once the task is complete. | <input type="checkbox"/> | | |

| Task grading rules | Task grade: |
|---|-------------|
| To achieve a pass : <ul style="list-style-type: none"> • all pass criteria must be met. | |
| To achieve a merit : <ul style="list-style-type: none"> • a minimum of 8/12 merit criteria must be met, and; • all pass criteria must be met, and; • candidates must not exceed the expected task time by more than 50%. | |
| To achieve a distinction : <ul style="list-style-type: none"> • a minimum of 8/12 distinction criteria must be met, and; • the remaining graded criteria at merit level must be met, and; • all pass criteria must be met, and; • candidates must not exceed the expected task time by more than 25%. | |
| Assessor Name | |
| Assessor Signature | |
| Date | |

Unit 246 Build solid and cavity walls to form craft masonry structures

Task 1 Build a one brick thick wall with pier and stone panels

Unit feedback and action planning form

| | |
|-----------------------|--|
| Unit title | |
| Candidate name | |

| Unit feedback | | |
|---------------|-------------|------------------|
| | | |
| Action plan | Target date | Achievement date |
| | | |

This unit feedback and action plan has been agreed by:

| Role | Print name | Signed | Date |
|-------------|------------|--------|------|
| Candidate | | | |
| Assessor | | | |
| Internal QA | | | |

Unit 246 Build solid and cavity walls to form craft masonry structures

Task 2 Erect a cavity wall

Task coversheet

| | |
|--------------------------|---|
| Expected time | 10 hours |
| Task instructions | <p>In this task you will be required to:</p> <ul style="list-style-type: none">• interpret drawings and specifications• complete a method statement and risk assessment• complete a resource checklist• set out blockwork• position mortar boards, blocks and bricks• build a cavity wall with quoin and junction• keep a clean work area• work safely at all times. |

Unit 246 Build solid and cavity walls to form craft masonry structures

Task 2 Erect a cavity wall

Drawings

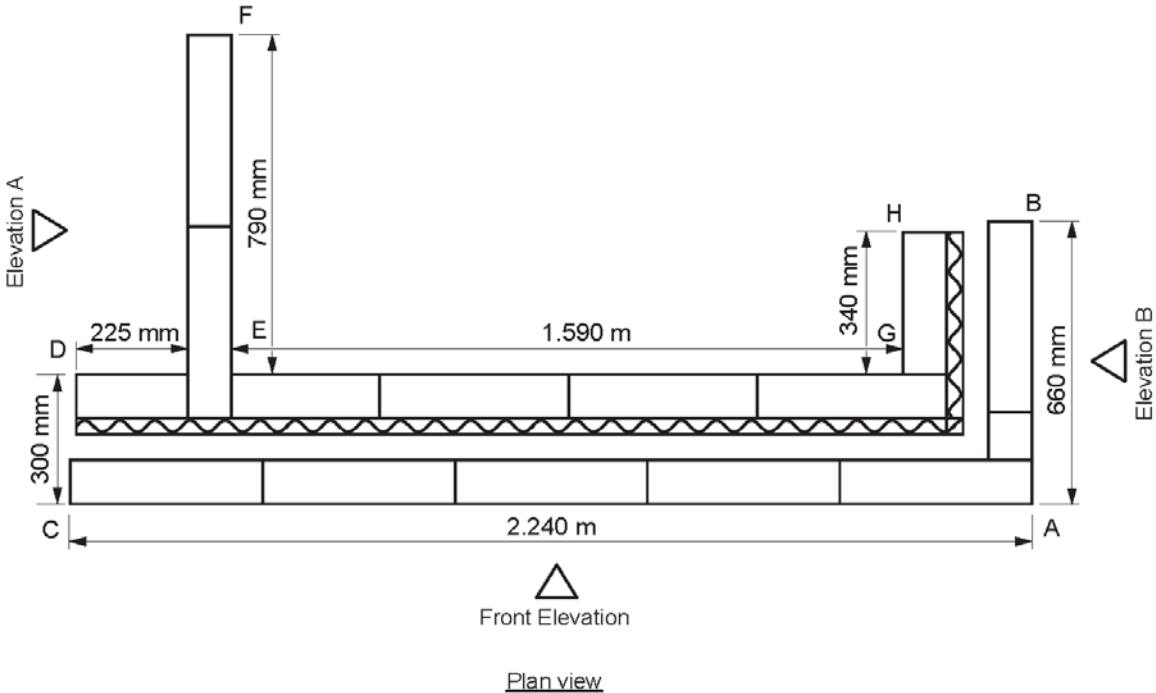
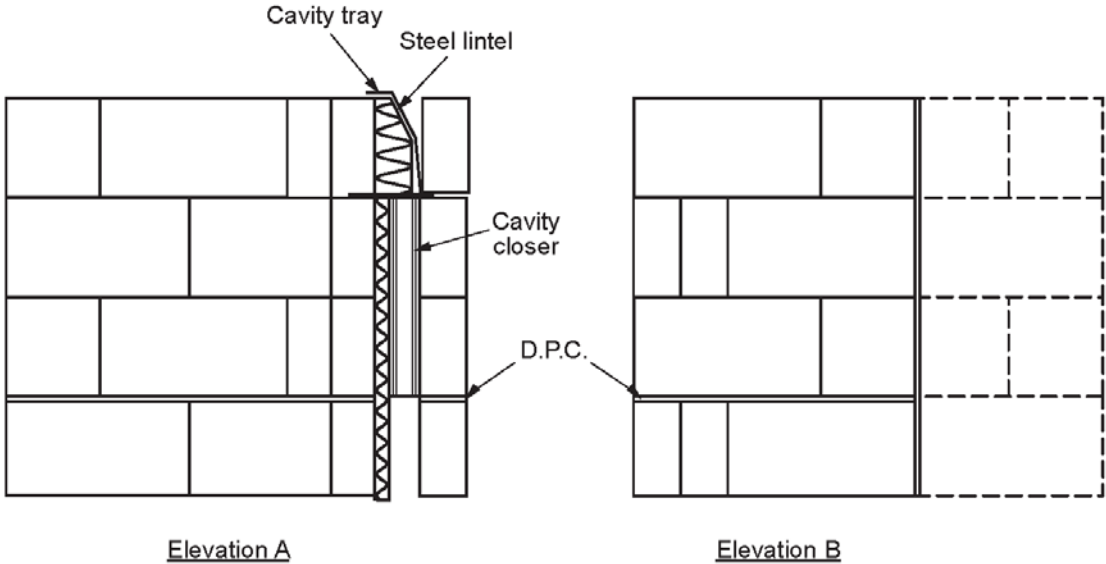
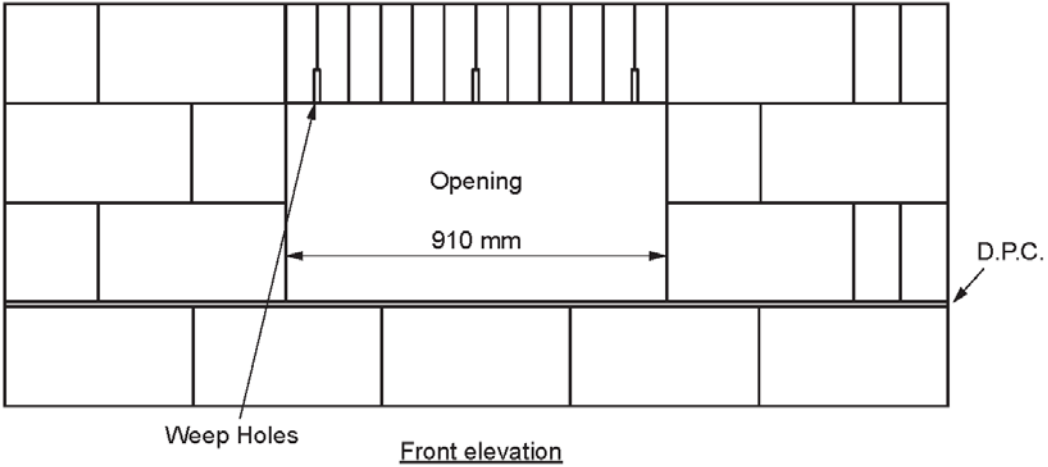

Unit 246 Build solid and cavity walls to form craft masonry structures

Task 2 Erect a cavity wall

Specifications

- Blockwork: 100 mm thick
- Joint finish: half round
- Insulation: partial fill
- Lintel: steel
- Cavity tray: flexible 450 mm
- Wall ties: in accordance with Building Regulations
- Solider course to project by 12 mm from face of the wall
- DPC to be lapped by 100 mm

Unit 246 Build solid and cavity walls to form craft masonry structures

Task 2 Erect a cavity wall

Method statement

| | | |
|---|-------|--------------|
| Department/Location | | |
| Risk Assessment No. | | |
| Description of the task/Activity | | |
| Personnel Involved | Names | Roles/Trades |
| Key Plant & Tools | | |
| Key Materials | | |
| Other Essential Equipment (ie access platforms/winches/ladders, etc) | | |
| Sequence of Operations (include sketches if required) | | |
| Other information & Comments | | |

Unit 246 Build solid and cavity walls to form craft masonry structures

Task 2 Erect a cavity wall

Risk assessment

| Candidate Name | | SEVERITY (S): Degree of harm which may be caused (including numbers affected) 1 = Minor Injury 2 = Major Injury 3 = Fatality | | LIKELIHOOD (L): Probability that event will occur 1 = Remote 2 = Possible 3 = Likely | | RISK RATING (RR): Severity x Likelihood 1-2 = Low 3-4 = Medium 6-9 = High | |
|----------------|---|---|-------------------|--|------------|---|--|
| Date | Activity | Hazard | Existing Controls | S (1-3) | L (1-3) | RR (S x L) | Actions needed |
| 18 July 2013 | Apply materials and fix tiles to surfaces | Chemical based adhesives | PPE | 1 | 2 | 2 | Implement sign off sheet to ensure PPE is worn |
| | | | | | | | |

| | | Likelihood | | |
|----------|---|------------|----------|-------------|
| | | Unlikely | Possible | Very likely |
| Severity | 1 Slight / minor injuries / minor damage | 1 | 2 | 3 |
| | 2 Medium injuries / significant damage | 2 | 4 | 6 |
| | 3 Major injury / extensive damage | 3 | 6 | 9 |

Likelihood

- 3 = Very likely
- 2 = Possible
- 1 = Unlikely

Severity

- 3 = Major injury / extensive damage
- 2 = Medium injury / significant damage
- 1 = Slight / minor damage

Key:

- 1 = Low risk, action should be taken to reduce the risk if reasonably practicable
- 2, 3, 4 = Medium risk, is a significant risk and would require an appropriate level of control measures.
- 6 & 9 = High risk, should not be undertaken without prior agreement.

Unit 246 Build solid and cavity walls to form craft masonry structures

Task 2 Erect a cavity wall

Observation checklist

| AC | The candidate has | Pass | Merit | Distinction |
|---------------|---|---------------------------------------|--------------------------------------|--------------------------------------|
| 2.1 | read drawings and specifications, and confirmed understanding of the task | <input type="checkbox"/> | | |
| 2.2 | completed the method statement | <input type="checkbox"/> | | |
| 2.3 | completed the risk assessment | <input type="checkbox"/> | | |
| 2.4, 2.5, 2.6 | completed the resource checklist | <input type="checkbox"/> | | |
| 5.1 | positioned components ready for use as required | <input type="checkbox"/> | | |
| 5.2 | accurately set out length of wall | <input type="checkbox"/> +/- 10 mm | <input type="checkbox"/> +/- 6 mm | <input type="checkbox"/> +/- 3 mm |
| | set out internal return to square | <input type="checkbox"/> +/- 6 mm | <input type="checkbox"/> +/- 4 mm | <input type="checkbox"/> +/- 2 mm |
| | set out external return to square | <input type="checkbox"/> +/- 6 mm | <input type="checkbox"/> +/- 4 mm | <input type="checkbox"/> +/- 2 mm |
| | set out internal junction to square | <input type="checkbox"/> +/- 6 mm | <input type="checkbox"/> +/- 4 mm | <input type="checkbox"/> +/- 2 mm |
| 5.3 | measured and safely cut blocks consistently and to the correct size | <input type="checkbox"/> +/- 8mm | <input type="checkbox"/> +/- 6 mm | <input type="checkbox"/> +/- 4 mm |
| 5.4 | maintained blockwork gauge over the height of the wall (measured from corner A) | <input type="checkbox"/> +/- 8 mm | <input type="checkbox"/> +/- 6 mm | <input type="checkbox"/> +/- 4 mm |
| | maintained inner leaf level | <input type="checkbox"/> +/- 10 mm | <input type="checkbox"/> +/- 6 mm | <input type="checkbox"/> +/- 3 mm |
| | maintained outer leaf level | <input type="checkbox"/> +/- 10 mm | <input type="checkbox"/> +/- 6 mm | <input type="checkbox"/> +/- 3 mm |
| | maintained plumb blockwork at area A (2 points) | <input type="checkbox"/> +/- 6 mm | <input type="checkbox"/> +/- 4 mm | <input type="checkbox"/> +/- 2 mm |
| | maintained plumb blockwork at area B (2 points) | <input type="checkbox"/> +/- 6 mm | <input type="checkbox"/> +/- 4 mm | <input type="checkbox"/> +/- 2 mm |
| | maintained plumb blockwork at area C (2 points) | <input type="checkbox"/> +/- 6 mm | <input type="checkbox"/> +/- 4 mm | <input type="checkbox"/> +/- 2 mm |
| | maintained plumb blockwork at window reveals at both sides | <input type="checkbox"/> +/- 6 mm | <input type="checkbox"/> +/- 4 mm | <input type="checkbox"/> +/- 2 mm |
| | maintained plumb blockwork at area D (2 points) | <input type="checkbox"/> +/- 6 mm | <input type="checkbox"/> +/- 4 mm | <input type="checkbox"/> +/- 2 mm |
| | maintained plumb blockwork at area E (2 points) | <input type="checkbox"/> +/- 6 mm | <input type="checkbox"/> +/- 4 mm | <input type="checkbox"/> +/- 2 mm |

| AC | The candidate has | Pass | Merit | Distinction |
|---------------------|---|---------------------------------------|--------------------------------------|--------------------------------------|
| | maintained plumb blockwork at area F (2 points) | <input type="checkbox"/> +/- 6 mm | <input type="checkbox"/> +/- 4 mm | <input type="checkbox"/> +/- 2 mm |
| | maintained plumb blockwork at area G (2 points) | <input type="checkbox"/> +/- 6 mm | <input type="checkbox"/> +/- 4 mm | <input type="checkbox"/> +/- 2 mm |
| | maintained plumb blockwork at area H (2 points) | <input type="checkbox"/> +/- 6 mm | <input type="checkbox"/> +/- 4 mm | <input type="checkbox"/> +/- 2 mm |
| | maintained face plane over blockwork | <input type="checkbox"/> +/- 8 mm | <input type="checkbox"/> +/- 6 mm | <input type="checkbox"/> +/- 4 mm |
| | laid DPC correctly | <input type="checkbox"/> | | |
| | cavity closed in accordance with Building Regulations | <input type="checkbox"/> | | |
| | positioned wall ties correctly | <input type="checkbox"/> | | |
| | maintained overall cavity size | <input type="checkbox"/> +/- 10 mm | <input type="checkbox"/> +/- 6 mm | <input type="checkbox"/> +/- 3 mm |
| | set out position of opening | <input type="checkbox"/> | | |
| | set out opening to correct size | <input type="checkbox"/> | | |
| | positioned lintel with correct bearing | <input type="checkbox"/> | | |
| | installed cavity tray over lintel and maintained cleanliness | <input type="checkbox"/> | | |
| | installed weep holes | <input type="checkbox"/> | | |
| | maintained plumb of soldiers | <input type="checkbox"/> +/- 4 mm | <input type="checkbox"/> +/- 3 mm | <input type="checkbox"/> +/- 2 mm |
| | maintained line of soldiers | <input type="checkbox"/> +/- 4 mm | <input type="checkbox"/> +/- 3 mm | <input type="checkbox"/> +/- 2 mm |
| 5.5 | positioned partial fill insulation in accordance with manufacturer's instructions | <input type="checkbox"/> | | |
| 5.6 | produced full and complete joints | <input type="checkbox"/> | | |
| | produced joint finishes as per specification | <input type="checkbox"/> | | |
| 2.7, 5.7, 5.8 | followed current environmental and relevant health and safety legislation | <input type="checkbox"/> | | |
| | used tools, equipment and materials in a safe manner | <input type="checkbox"/> | | |
| | used and maintained PPE as appropriate | <input type="checkbox"/> | | |
| | maintained a clean and safe working area | <input type="checkbox"/> | | |
| | cleaned and returned all tools and equipment once the task is complete. | <input type="checkbox"/> | | |

| Task grading rules | Task grade: |
|--|-------------|
| To achieve a pass : <ul style="list-style-type: none"> • all pass criteria must be met. | |
| To achieve a merit : <ul style="list-style-type: none"> • a minimum of 13/21 merit criteria must be met, and; • all pass criteria must be met, and; • candidates must not exceed the expected task time by more than 50%. | |
| To achieve a distinction : <ul style="list-style-type: none"> • a minimum of 13/21 distinction criteria must be met, and; • the remaining graded criteria at merit level must be met, and; • all pass criteria must be met, and; • candidates must not exceed the expected task time by more than 25%. | |
| Assessor Name | |
| Assessor Signature | |
| Date | |

Unit 246 Build solid and cavity walls to form craft masonry structures

Task 2 Erect a cavity wall

Unit feedback and action planning form

| | |
|-----------------------|--|
| Unit title | |
| Candidate name | |

| Unit feedback | | |
|----------------------|--------------------|-------------------------|
| | | |
| Action plan | Target date | Achievement date |
| | | |

This unit feedback and action plan has been agreed by:

| Role | Print name | Signed | Date |
|-------------|-------------------|---------------|-------------|
| Candidate | | | |
| Assessor | | | |
| Internal QA | | | |

Unit 247 Internal and external finishes for craft masonry structures

Task 1 Produce internal finishes on a solid and a plasterboard background

Task coversheet

| | |
|--------------------------|---|
| Expected time | 6 hours (not including drying times between coats) |
| Task instructions | <p>In this task you will be required to:</p> <ul style="list-style-type: none">• read the drawing and specification• complete a method statement and risk assessment• complete a resource checklist• apply plasterboard to an interior wall• apply a backing coat to solid background• apply finishing coat to prepared solid background• apply finishing coat to plasterboard• keep a clean work area• work safely at all times. |

Unit 247 Internal and external finishes for craft masonry structures

Task 1 Produce internal finishes on a solid and a plasterboard background

Drawings

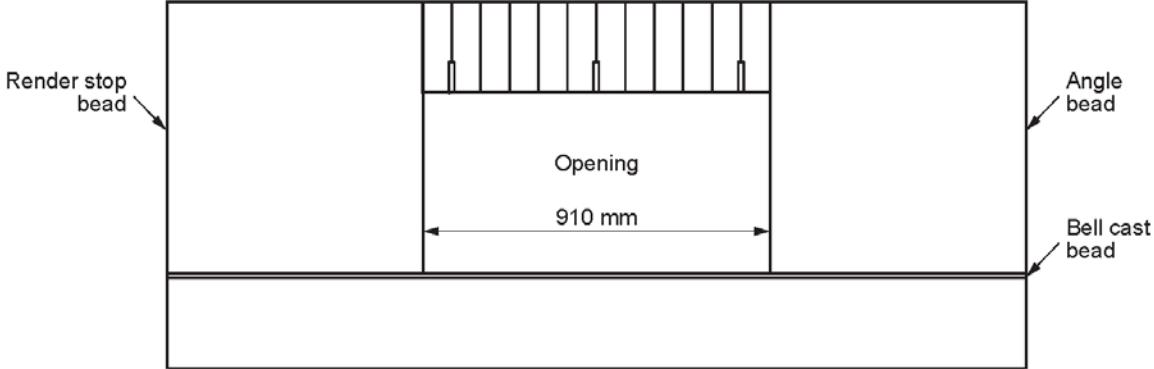

Front elevation

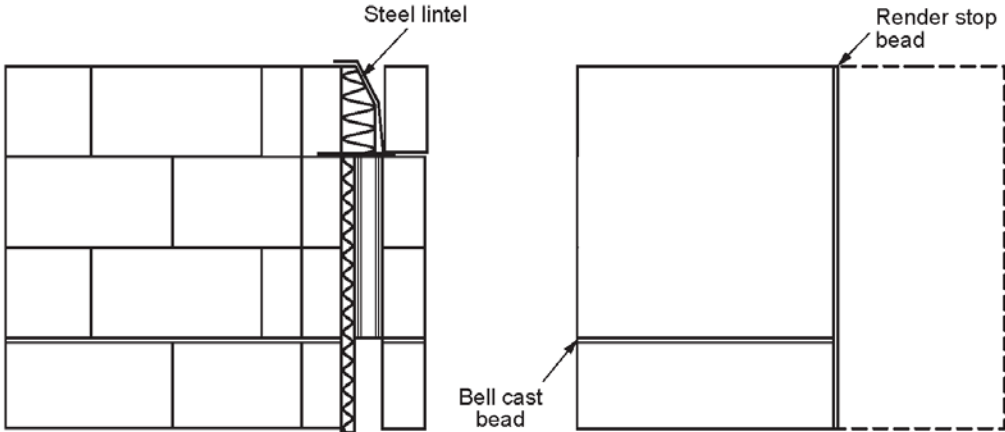

Elevation A

Elevation B

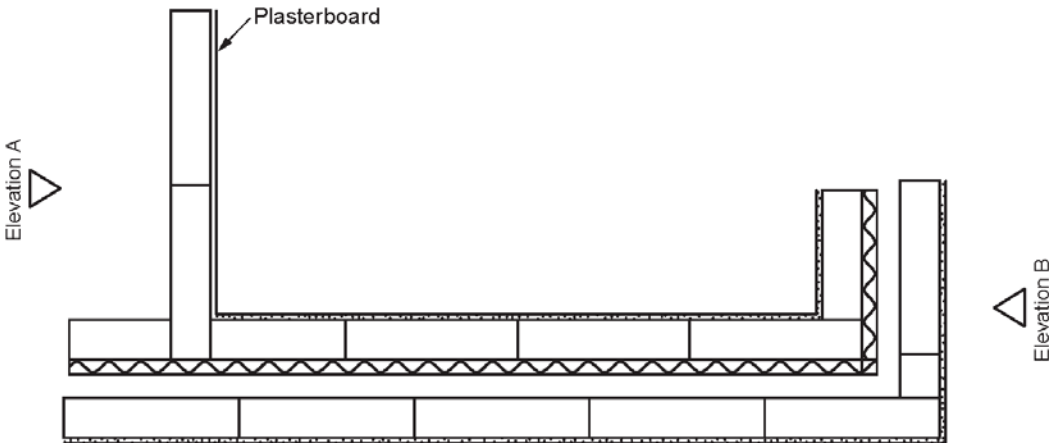

Front Elevation

Plan view

Unit 247 Internal and external finishes for craft masonry structures

Task 1 Produce internal finishes on a solid and a plasterboard background

Specifications

- Two coat work to solid walls
- Top edge finished to a rule
- Plasterboard background to inner face of junction wall (dot and dab)
- Two coat work 15 mm
- Finishing coat 3-4 mm

Unit 247 Internal and external finishes for craft masonry structures

Task 1 Produce internal finishes on a solid and a plasterboard background

Method statement

| | | |
|---|-------|--------------|
| Department/Location | | |
| Risk Assessment No. | | |
| Description of the task/Activity | | |
| Personnel Involved | Names | Roles/Trades |
| Key Plant & Tools | | |
| Key Materials | | |
| Other Essential Equipment (ie access platforms/winches/ladders, etc) | | |
| Sequence of Operations (include sketches if required) | | |
| Other information & Comments | | |

Unit 247 Internal and external finishes for craft masonry structures

Task 1 Produce internal finishes on a solid and a plasterboard background

Risk assessment

| Candidate Name | | SEVERITY (S): Degree of harm which may be caused (including numbers affected) 1 = Minor Injury 2 = Major Injury 3 = Fatality | | LIKELIHOOD (L): Probability that event will occur 1 = Remote 2 = Possible 3 = Likely | | RISK RATING (RR): Severity x Likelihood 1-2 = Low 3-4 = Medium 6-9 = High | |
|----------------|---|---|-------------------|--|------------|---|--|
| Date | Activity | Hazard | Existing Controls | S (1-3) | L (1-3) | RR (S x L) | Actions needed |
| 18 July 2013 | Apply materials and fix tiles to surfaces | Chemical based adhesives | PPE | 1 | 2 | 2 | Implement sign off sheet to ensure PPE is worn |
| | | | | | | | |

| | | Likelihood | | |
|----------|---|------------|----------|-------------|
| | | Unlikely | Possible | Very likely |
| Severity | 1 Slight / minor injuries / minor damage | 1 | 2 | 3 |
| | 2 Medium injuries / significant damage | 2 | 4 | 6 |
| | 3 Major injury / extensive damage | 3 | 6 | 9 |

Likelihood

- 3 = Very likely
- 2 = Possible
- 1 = Unlikely

Severity

- 3 = Major injury / extensive damage
- 2 = Medium injury / significant damage
- 1 = Slight / minor damage

Key:

- 1 = Low risk, action should be taken to reduce the risk if reasonably practicable
- 2, 3, 4 = Medium risk, is a significant risk and would require an appropriate level of control measures.
- 6 & 9 = High risk, should not be undertaken without prior agreement.

Unit 247 Internal and external finishes for craft masonry structures

Task 1 Produce internal finishes on a solid and a plasterboard background

Observation checklist

| AC | The candidate has | Pass | Merit | Distinction |
|----------------|---|--|--|---|
| 2.1 | read drawing and specification, and confirmed understanding of the task | <input type="checkbox"/> | | |
| 2.2 | completed the method statement | <input type="checkbox"/> | | |
| 2.3 | completed the risk assessment | <input type="checkbox"/> | | |
| 2.4, 2.5, 2.6 | completed the resource checklist | <input type="checkbox"/> | | |
| 4.1 | applied plasterboard to junction wall | <input type="checkbox"/> | | |
| | applied plasterboard plumb | <input type="checkbox"/> +/- 4mm | <input type="checkbox"/> +/- 2mm | <input type="checkbox"/> +/- 1mm |
| | applied plasterboard without face deviation | <input type="checkbox"/> +/- 4mm | <input type="checkbox"/> +/- 2mm | <input type="checkbox"/> +/- 1mm |
| 4.4 | applied beads and trims plumb | <input type="checkbox"/> +/- 4mm | <input type="checkbox"/> +/- 3mm | <input type="checkbox"/> +/- 2mm |
| 4.5, 5.3 | mixed materials in accordance with manufacturer's instructions | <input type="checkbox"/> | | |
| 4.3 | controlled suction for solid background | <input type="checkbox"/> | | |
| 4.2 | applied backing material to solid background | <input type="checkbox"/> | | |
| 4.6 | applied finishing coat to plasterboard without face deviation | <input type="checkbox"/> +/- 3mm, and no more than 3 minor defects | <input type="checkbox"/> +/- 2mm, and no more than 2 minor defects | <input type="checkbox"/> +/- 1mm, and no more than 1 minor defect |
| 4.7 | applied finishing coat to solid background without face deviation | <input type="checkbox"/> +/- 4mm, and no more than 3 minor defects | <input type="checkbox"/> +/- 3mm, and no more than 2 minor defects | <input type="checkbox"/> +/- 2mm, and no more than 1 minor defect |
| 4.8, 5.5 | formed internal angles to solid and plasterboard backgrounds to plumb | <input type="checkbox"/> +/- 3mm | <input type="checkbox"/> +/- 2mm | <input type="checkbox"/> +/- 1mm |
| | formed external angles to window reveals plumb | <input type="checkbox"/> +/- 3mm | <input type="checkbox"/> +/- 2mm | <input type="checkbox"/> +/- 1mm |
| 2.7, 4.9, 4.10 | used tools, equipment and materials in a safe manner | <input type="checkbox"/> | | |
| | used and maintained PPE as appropriate | <input type="checkbox"/> | | |

| AC | The candidate has | Pass | Merit | Distinction |
|----|--|--------------------------|-------|-------------|
| | maintained a clean and safe working area | <input type="checkbox"/> | | |
| | cleaned and returned all tools and equipment once the task is complete | <input type="checkbox"/> | | |
| | followed current environmental and relevant health and safety legislation. | <input type="checkbox"/> | | |

| Task grading rules | Task grade: |
|--|-------------|
| <p>To achieve a pass:</p> <ul style="list-style-type: none"> • all pass criteria must be met. | |
| <p>To achieve a merit:</p> <ul style="list-style-type: none"> • a minimum of 4/7 merit criteria must be met, and; • all pass criteria must be met, and; • candidates must not exceed the expected task time by more than 50%. | |
| <p>To achieve a distinction:</p> <ul style="list-style-type: none"> • a minimum of 4/7 distinction criteria must be met, and; • the remaining graded criteria at merit level must be met, and; • all pass criteria must be met, and; • candidates must not exceed the expected task time by more than 25%. | |
| Assessor Name | |
| Assessor Signature | |
| Date | |

Unit 247 Internal and external finishes for craft masonry structures

Task 1 Produce internal finishes on a solid and a plasterboard background

Unit feedback and action planning form

| | |
|-----------------------|--|
| Unit title | |
| Candidate name | |

| Unit feedback | | |
|---------------|-------------|------------------|
| | | |
| Action plan | Target date | Achievement date |
| | | |

This unit feedback and action plan has been agreed by:

| Role | Print name | Signed | Date |
|-------------|------------|--------|------|
| Candidate | | | |
| Assessor | | | |
| Internal QA | | | |

Unit 247 Internal and external finishes for craft masonry structures

Task 2 Produce an external finish on a solid background

Task coversheet

| | |
|--------------------------|---|
| Expected time | 4 hours (not including drying times between coats) |
| Task instructions | <p>In this task you will:</p> <ul style="list-style-type: none">• read the drawing and specification• complete a method statement and risk assessment• complete a resource checklist• prepare a solid background• apply a scratch coat to a solid background• apply and finish a floating coat to a prepared background• keep a clean work area• work safely at all times. |

Unit 247 Internal and external finishes for craft masonry structures

Task 2 Produce an external finish on a solid background

Drawings

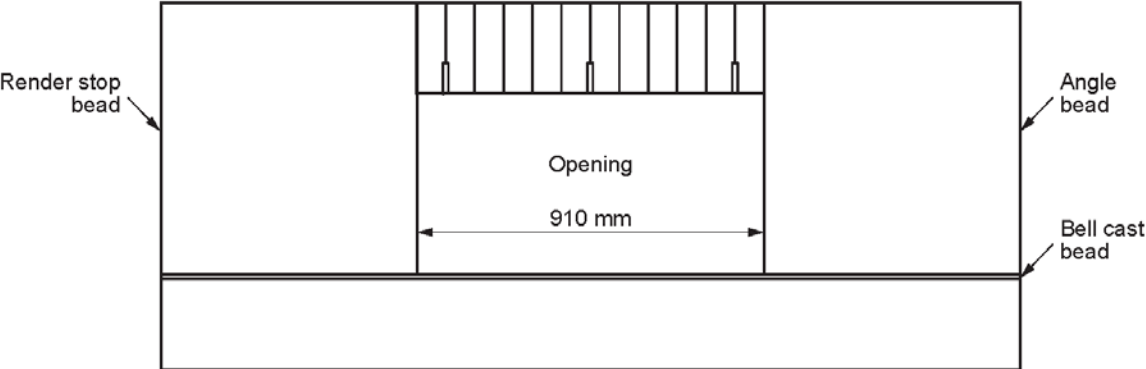

Front elevation

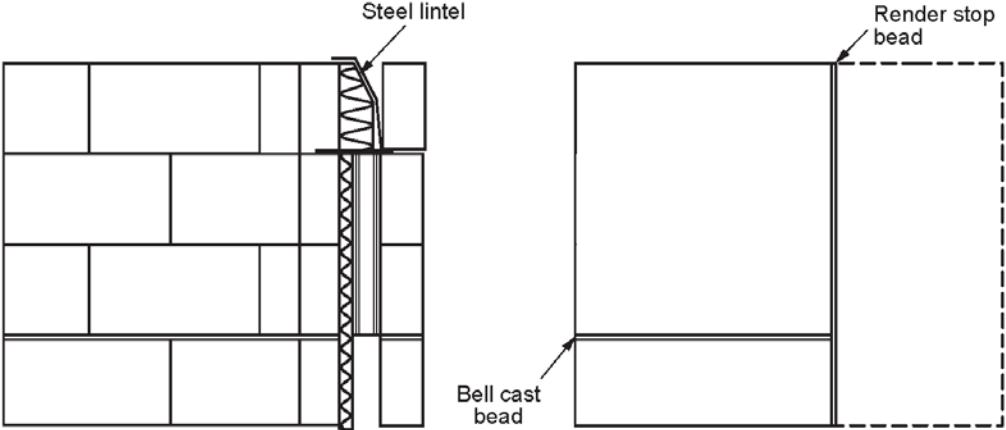

Elevation A

Elevation B

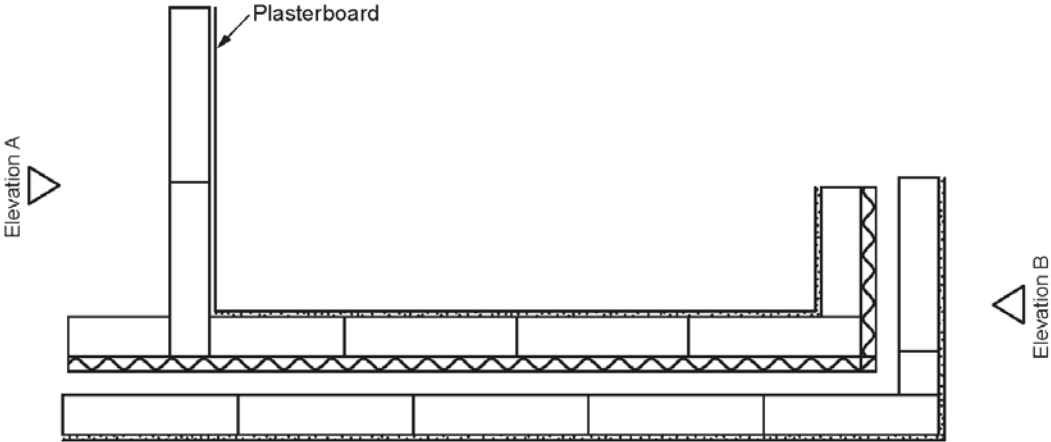

Front Elevation

Plan view

Unit 247 Internal and external finishes for craft masonry structures

Task 2 Produce an external finish on a solid background

Specifications

- Corner bead fitted to all external corners including window reveals
- Top edge finished to a rule
- Soldier course to be left exposed
- Two coat plain faced render
- Two coat work 15 mm

Unit 247 Internal and external finishes for craft masonry structures

Task 2 Produce an external finish on a solid background

Method statement

| | | |
|---|-------|--------------|
| Department/Location | | |
| Risk Assessment No. | | |
| Description of the task/Activity | | |
| Personnel Involved | Names | Roles/Trades |
| Key Plant & Tools | | |
| Key Materials | | |
| Other Essential Equipment (ie access platforms/winches/ladders, etc) | | |
| Sequence of Operations (include sketches if required) | | |
| Other information & Comments | | |

Unit 247 Internal and external finishes for craft masonry structures

Task 2 Produce an external finish on a solid background

Risk assessment

| Candidate Name | | SEVERITY (S): Degree of harm which may be caused (including numbers affected) 1 = Minor Injury 2 = Major Injury 3 = Fatality | | LIKELIHOOD (L): Probability that event will occur 1 = Remote 2 = Possible 3 = Likely | | RISK RATING (RR): Severity x Likelihood 1-2 = Low 3-4 = Medium 6-9 = High | |
|----------------|---|---|-------------------|---|---------|--|--|
| Date | Activity | Hazard | Existing Controls | S (1-3) | L (1-3) | RR (S x L) | Actions needed |
| 18 July 2013 | Apply materials and fix tiles to surfaces | Chemical based adhesives | PPE | 1 | 2 | 2 | Implement sign off sheet to ensure PPE is worn |
| | | | | | | | |

| | | Likelihood | | |
|----------|---|------------|----------|-------------|
| | | Unlikely | Possible | Very likely |
| Severity | 1 Slight / minor injuries / minor damage | 1 | 2 | 3 |
| | 2 Medium injuries / significant damage | 2 | 4 | 6 |
| | 3 Major injury / extensive damage | 3 | 6 | 9 |

Likelihood

- 3 = Very likely
- 2 = Possible
- 1 = Unlikely

Severity

- 3 = Major injury / extensive damage
- 2 = Medium injury / significant damage
- 1 = Slight / minor damage

Key:

- 1 = Low risk, action should be taken to reduce the risk if reasonably practicable
- 2, 3, 4 = Medium risk, is a significant risk and would require an appropriate level of control measures.
- 6 & 9 = High risk, should not be undertaken without prior agreement.

Unit 247 Internal and external finishes for craft masonry structures

Task 2 Produce an external finish on a solid background

Observation checklist

| AC | The candidate has | Pass | Merit | Distinction |
|---------------|--|-------------------------------------|-------------------------------------|-------------------------------------|
| 2.1 | read drawing and specification, and confirmed understanding of the task | <input type="checkbox"/> | | |
| 2.2 | completed the method statement | <input type="checkbox"/> | | |
| 2.3 | completed the risk assessment | <input type="checkbox"/> | | |
| 2.4, 2.5, 2.6 | completed the resource checklist | <input type="checkbox"/> | | |
| 5.1 | prepared solid background to receive scratch coat | <input type="checkbox"/> | | |
| | prepared background to receive render coat | <input type="checkbox"/> | | |
| 5.2 | applied beads and trims plumb | <input type="checkbox"/> +/- 4mm | <input type="checkbox"/> +/- 3mm | <input type="checkbox"/> +/- 2mm |
| | applied bell cast bead to level (front elevation) | <input type="checkbox"/> +/- 8mm | <input type="checkbox"/> +/- 6mm | <input type="checkbox"/> +/- 4mm |
| | applied bell cast bead to level (elevation B) | <input type="checkbox"/> +/- 4mm | <input type="checkbox"/> +/- 3mm | <input type="checkbox"/> +/- 2mm |
| 5.4 | applied scratch coat to whole wall with adequate key | <input type="checkbox"/> | | |
| | applied floating coat to main wall, minimising face deviation (front elevation) | <input type="checkbox"/> +/- 6mm | <input type="checkbox"/> +/- 4mm | <input type="checkbox"/> +/- 2mm |
| | applied floating coat to main wall, minimising face deviation (elevation B) | <input type="checkbox"/> +/- 3mm | <input type="checkbox"/> +/- 2mm | <input type="checkbox"/> +/- 1mm |
| | applied floating coat below bell cast, minimising face deviation (front elevation) | <input type="checkbox"/> +/- 6mm | <input type="checkbox"/> +/- 4mm | <input type="checkbox"/> +/- 2mm |
| | applied floating coat below bell cast, minimising face deviation (elevation B) | <input type="checkbox"/> +/- 3mm | <input type="checkbox"/> +/- 2mm | <input type="checkbox"/> +/- 1mm |
| 5.5 | formed external angle | <input type="checkbox"/> | | |
| 2.7, 5.6, 5.7 | followed current environmental and relevant health and safety legislation | <input type="checkbox"/> | | |
| | used tools, equipment and materials in a safe manner | <input type="checkbox"/> | | |
| | used and maintained PPE as appropriate | <input type="checkbox"/> | | |
| | maintained a clean and safe working area | <input type="checkbox"/> | | |
| | cleaned and returned all tools and equipment once the task is complete. | <input type="checkbox"/> | | |

| Task grading rules | Task grade: |
|--|-------------|
| To achieve a pass : <ul style="list-style-type: none"> • all pass criteria must be met. | |
| To achieve a merit : <ul style="list-style-type: none"> • a minimum of 4/7 merit criteria must be met, and; • all pass criteria must be met, and; • candidates must not exceed the expected task time by more than 50%. | |
| To achieve a distinction : <ul style="list-style-type: none"> • a minimum of 4/7 distinction criteria must be met, and; • the remaining graded criteria at merit level must be met, and; • all pass criteria must be met, and; • candidates must not exceed the expected task time by more than 25%. | |
| Assessor Name | |
| Assessor Signature | |
| Date | |

Unit 247 Internal and external finishes for craft masonry structures

Task 2 Produce an external finish on a solid background

Unit feedback and action planning form

| | |
|-----------------------|--|
| Unit title | |
| Candidate name | |

| Unit feedback | | |
|----------------------|--------------------|-------------------------|
| | | |
| Action plan | Target date | Achievement date |
| | | |

This unit feedback and action plan has been agreed by:

| Role | Print name | Signed | Date |
|-------------|-------------------|---------------|-------------|
| Candidate | | | |
| Assessor | | | |
| Internal QA | | | |

Unit 248 Install pitched roof systems for small-scale building projects

Task 1 Install two roof systems to a small pitched roof

Task coversheet

| | |
|--------------------------|--|
| Expected time | 8 hours |
| Task instructions | <p>In this task you will be required to:</p> <ul style="list-style-type: none">• read the drawing and specification• complete a method statement and risk assessment• complete a resource checklist• install a roofing background• install two roof systems• keep a clean work area• work safely at all times. |

Unit 248 Install pitched roof systems for small-scale building projects

Task 1 Install two roof systems to a small pitched roof

Drawings

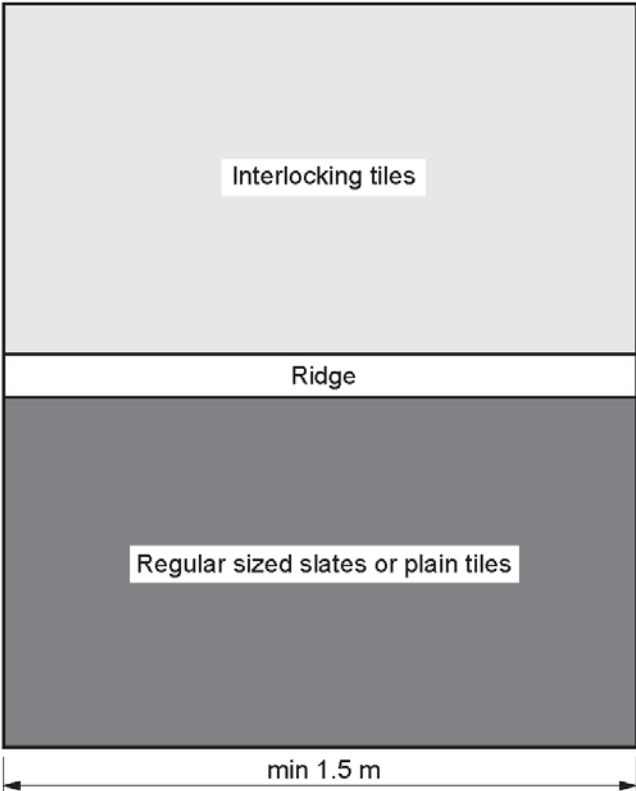
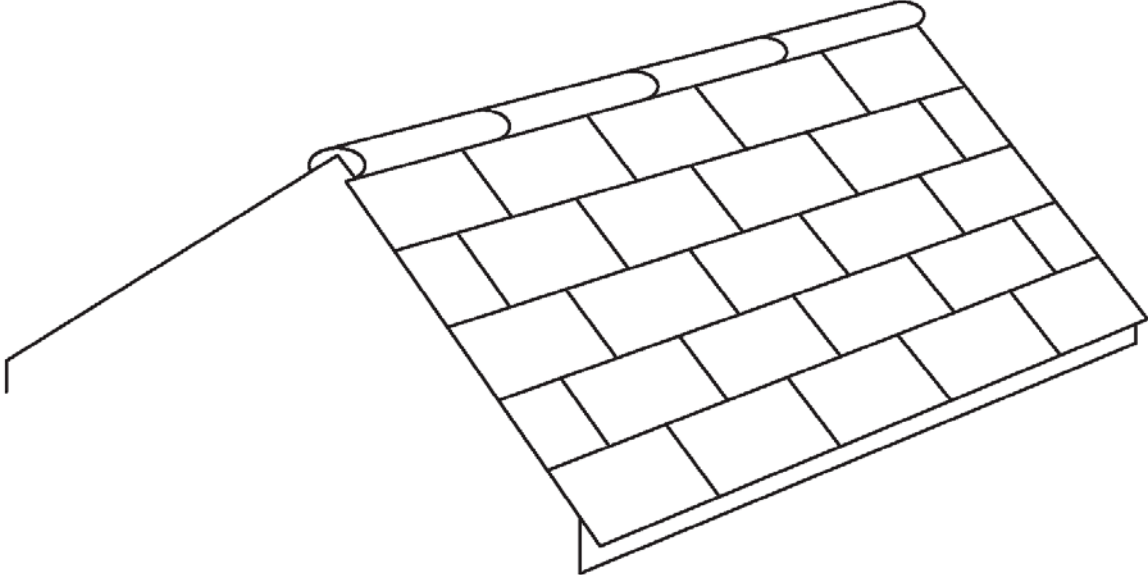

Unit 248 Install pitched roof systems for small-scale building projects

Task 1 Install two roof systems to a small pitched roof

Specifications

- Rafter length: 980 mm
- Fascia length: min 1.5 m (and no more than 2.4 m)
- Roof system: 1 side interlocking tiles, 1 side regular sized slates or plain tiles
- Verge system: dry and/or wet in accordance with chosen roof systems
- Ridge: dry or wet in accordance with centre discretion

Unit 248 Install pitched roof systems for small-scale building projects

Task 1 Install two roof systems to a small pitched roof

Method statement

| | | |
|---|-------|--------------|
| Department/Location | | |
| Risk Assessment No. | | |
| Description of the task/Activity | | |
| Personnel Involved | Names | Roles/Trades |
| Key Plant & Tools | | |
| Key Materials | | |
| Other Essential Equipment (ie access platforms/winches/ladders, etc) | | |
| Sequence of Operations (include sketches if required) | | |
| Other information & Comments | | |

Unit 248 Install pitched roof systems for small-scale building projects

Task 1 Install two roof systems to a small pitched roof

Risk assessment

| Candidate Name | | SEVERITY (S): Degree of harm which may be caused (including numbers affected) 1 = Minor Injury 2 = Major Injury 3 = Fatality | | LIKELIHOOD (L): Probability that event will occur 1 = Remote 2 = Possible 3 = Likely | | RISK RATING (RR): Severity x Likelihood 1-2 = Low 3-4 = Medium 6-9 = High | |
|----------------|---|---|-------------------|--|------------|---|--|
| Date | Activity | Hazard | Existing Controls | S (1-3) | L (1-3) | RR (S x L) | Actions needed |
| 18 July 2013 | Apply materials and fix tiles to surfaces | Chemical based adhesives | PPE | 1 | 2 | 2 | Implement sign off sheet to ensure PPE is worn |
| | | | | | | | |

| | | Likelihood | | |
|----------|---|------------|----------|-------------|
| | | Unlikely | Possible | Very likely |
| Severity | 1 Slight / minor injuries / minor damage | 1 | 2 | 3 |
| | 2 Medium injuries / significant damage | 2 | 4 | 6 |
| | 3 Major injury / extensive damage | 3 | 6 | 9 |

Likelihood

- 3 = Very likely
- 2 = Possible
- 1 = Unlikely

Severity

- 3 = Major injury / extensive damage
- 2 = Medium injury / significant damage
- 1 = Slight / minor damage

Key:

- 1 = Low risk, action should be taken to reduce the risk if reasonably practicable
- 2, 3, 4 = Medium risk, is a significant risk and would require an appropriate level of control measures.
- 6 & 9 = High risk, should not be undertaken without prior agreement.

Unit 248 Install pitched roof systems for small-scale building projects

Task 1 Install two roof systems to a small pitched roof

Observation checklist

| AC | The candidate has | Pass | Merit | Distinction |
|---------------------|--|--|--|---|
| 2.1 | read drawing and specification, and confirmed understanding of the task | <input type="checkbox"/> | | |
| 2.2 | completed the method statement | <input type="checkbox"/> | | |
| 2.3 | completed the risk assessment | <input type="checkbox"/> | | |
| 2.4, 2.5, 2.6 | completed the resource checklist | <input type="checkbox"/> | | |
| 4.1 | set out to install background materials | <input type="checkbox"/> | | |
| 4.2 | fixed eaves protection system with a side lap of 150 mm | <input type="checkbox"/> +/- 10 mm | <input type="checkbox"/> +/- 6 mm | <input type="checkbox"/> +/- 4 mm |
| 4.3 | fixed underlay to ensure overlap of 150 mm onto EPS | <input type="checkbox"/> +/- 10 mm | <input type="checkbox"/> +/- 6 mm | <input type="checkbox"/> +/- 4 mm |
| | fixed underlay to ensure sag of 8-10 mm | <input type="checkbox"/> +/- 4 mm | <input type="checkbox"/> +/- 2 mm | <input type="checkbox"/> +/- 0 mm |
| 4.4 | fixed battens to even gauge | <input type="checkbox"/> +/- 6 mm | <input type="checkbox"/> +/- 4 mm | <input type="checkbox"/> +/- 2 mm |
| | fixed battens to line | <input type="checkbox"/> +/- 6 mm | <input type="checkbox"/> +/- 4 mm | <input type="checkbox"/> +/- 2 mm |
| 6.1 | set out to install roof systems with perpendicular lines | <input type="checkbox"/> | | |
| | maintained half bond to perpendicular lines | <input type="checkbox"/> +/- 3 mm | <input type="checkbox"/> +/- 2 mm | <input type="checkbox"/> +/- 1 mm |
| 6.2, 6.3 | installed interlocking tiles with uniform spacing in accordance with manufacturer's information | <input type="checkbox"/> 80% with uniform spacing | <input type="checkbox"/> 90% with uniform spacing | <input type="checkbox"/> 100% with uniform spacing |
| | <input type="checkbox"/> installed regular sized slates in accordance with industry standards or <input type="checkbox"/> installed plain tiles in accordance with manufacturer's information | <input type="checkbox"/> 80% with uniform spacing | <input type="checkbox"/> 90% with uniform spacing | <input type="checkbox"/> 100% with uniform spacing |
| 4.5, 6.3 | fixed dry verge in accordance with manufacturer's information | <input type="checkbox"/> | | |

| AC | The candidate has | Pass | Merit | Distinction |
|-------------------------------------|---|---|---|---|
| 4.5 | fixed wet verge | <input type="checkbox"/> neat pointing with no more than 2 minor defects | <input type="checkbox"/> neat pointing with no more than 1 minor defects | <input type="checkbox"/> neat pointing with no defects |
| 6.2 | fixed dry ridge system | <input type="checkbox"/> | | |
| 2.7, 4.6, 4.7, 6.4, 6.5 | followed current environmental and relevant health and safety legislation | <input type="checkbox"/> | | |
| | used tools, equipment and materials in a safe manner | <input type="checkbox"/> | | |
| | used and maintained PPE as appropriate | <input type="checkbox"/> | | |
| | maintained a clean and safe working area | <input type="checkbox"/> | | |
| | cleaned and returned all tools and equipment once the task is complete. | <input type="checkbox"/> | | |

| Task grading rules | Task grade: |
|--|-------------|
| <p>To achieve a pass:</p> <ul style="list-style-type: none"> • all pass criteria must be met. | |
| <p>To achieve a merit:</p> <ul style="list-style-type: none"> • a minimum of 6/9 merit criteria must be met, and; • all pass criteria must be met, and; • candidates must not exceed the expected task time by more than 50%. | |
| <p>To achieve a distinction:</p> <ul style="list-style-type: none"> • a minimum of 6/9 distinction criteria must be met, and; • the remaining graded criteria at merit level must be met, and; • all pass criteria must be met, and; • candidates must not exceed the expected task time by more than 25%. | |
| Assessor Name | |
| Assessor Signature | |
| Date | |

Unit 248 Install pitched roof systems for small-scale building projects

Task 1 Install two roof systems to a small pitched roof

Unit feedback and action planning form

| | |
|-----------------------|--|
| Unit title | |
| Candidate name | |

| Unit feedback | | |
|---------------|-------------|------------------|
| | | |
| Action plan | Target date | Achievement date |
| | | |

This unit feedback and action plan has been agreed by:

| Role | Print name | Signed | Date |
|-------------|------------|--------|------|
| Candidate | | | |
| Assessor | | | |
| Internal QA | | | |

Published by City & Guilds
1 Giltspur Street
London
EC1A 9DD
T +44 (0)844 543 0000
F +44 (0)20 7294 2413
www.cityandguilds.com

**City & Guilds is a registered charity
established to promote education
and training**

About City & Guilds

As the UK's leading vocational education organisation, City & Guilds is leading the talent revolution by inspiring people to unlock their potential and develop their skills. We offer over 500 qualifications across 28 industries through 8500 centres worldwide and award around two million certificates every year. City & Guilds is recognised and respected by employers across the world as a sign of quality and exceptional training.

City & Guilds Group

The City & Guilds Group operates from three major hubs: London (servicing Europe, the Caribbean and Americas), Johannesburg (servicing Africa), and Singapore (servicing Asia, Australia and New Zealand). The Group also includes the Institute of Leadership & Management (management and leadership qualifications), City & Guilds Land Based Services (land-based qualifications), the Centre for Skills Development (CSD works to improve the policy and practice of vocational education and training worldwide) and Learning Assistant (an online e-portfolio).

Copyright

The content of this document is, unless otherwise indicated, © The City and Guilds of London Institute and may not be copied, reproduced or distributed without prior written consent. However, approved City & Guilds centres and candidates studying for City & Guilds qualifications may photocopy this document free of charge and/or include a PDF version of it on centre intranets on the following conditions:

- centre staff may copy the material only for the purpose of teaching candidates working towards a City & Guilds qualification, or for internal administration purposes
- candidates may copy the material only for their own use when working towards a City & Guilds qualification

The *Standard Copying Conditions* (see the City & Guilds website) also apply.

Published by City & Guilds, a registered charity established to promote education and training

Every effort has been made to ensure that the information contained in this publication is true and correct at the time of going to press. However, City & Guilds' products and services are subject to continuous development and improvement and the right is reserved to change products and services from time to time. City & Guilds cannot accept liability for loss or damage arising from the use of information in this publication.