

T Level Technical Qualification in Onsite Construction

Plastering

(8711-38) (308)

Candidate Pack

Practical Assignment - Sample

Contents

Assessment.....	3
Candidate guidance	4
Assignment brief.....	6
Task 1 – Prepare and plan backgrounds for installation	12
Task 2 – Plaster and render installations.....	13
Task 3 - Repair to plaster surfaces.....	15

SAMPLE

Version and date	Change detail	Section
1.1 Jan 2021	Minor amendment to additional evidence requirements to Video and Photograph requirements for installation of plasterboard and beads - changed for clarity	Task specific guidance – Additional evidence of candidate performance that must be captured for marking: Assessor Observation Task 2a
1.1 Jan 2021	Removal of “use of tools (and equipment) “ in what must be produced for marking	Task specific guidance – Additional evidence of candidate performance that must be captured for marking: Assessor Observation Task 2 a and b – Pg. 13, Task 2c Pg. 14 External render work and Task 3 – Pg. 15

SAMPLE

Assessment

This assessment is for the Plastering occupational specialism component of the Technical Qualification. This pack consists of a practical assignment that includes a project brief including drawing and diagrams as necessary along with several tasks for you to complete.

SAMPLE

Candidate guidance

General guidance

This is a formal assessment that you will be marked and graded on. You will be marked on the quality and accuracy of the work you produce. It is therefore important that you carry your work out to the highest standard you can.

Plagiarism

This is an assessment of your abilities, so the work must be all your own work and carried out under the conditions stated. You will be asked to sign a declaration that you have not had any help with the assignment.

Your tutor is allowed to give you some help understanding the instructions if necessary, but they will record any other guidance you need, and this will be taken into account during marking.

Plagiarism is the failure to acknowledge sources properly and/or the submission of another person's work as if it were your own. Plagiarism is not allowed in this project.

Where research is allowed, your tutor must be able to identify which work you have done yourself, and what you have found from other sources. It is therefore important to make sure you acknowledge sources used and clearly reference any information taken from them.

Timings and planning

You are advised to study the details of the assessment before starting.

You should check with your tutor that you have all the relevant materials, equipment, and information/data sources that you need before starting the assessment.

You should take care when planning to make sure you have divided the time available between parts of the assignment tasks appropriately. Timings for tasks are provided within this pack to support with planning and time allocation.

If you have a good reason for needing more time, you will need to explain the reasons to your tutor and agree a new deadline date. Changes to dates will be at the discretion of the tutor, and they may not mark work that is handed in after the agreed deadlines.

If you have a good reason for needing more time, you will need to explain the reasons to your tutor, and this must be agreed by City & Guilds.

Health and Safety

You must always work safely, in particular while you are carrying out practical tasks.

You must always follow any relevant Health and Safety regulations, Risk Assessments, and codes of practice in line with centre requirements.

If your tutor sees you working in a way that is unsafe for yourself or others, they will highlight the issue and ask you to stop the task immediately. Your tutor will not be able to reassess you until they are sure you are ready for assessment and can work safely.

Presentation of work

Presentation of work must be appropriate to the task.

You should make sure that each piece of evidence including any forms are clearly labelled with your name and the project reference.

All electronic files must be given a clear file name that allows your tutor to identify it as your work.

Written work may be word-processed or handwritten unless stated otherwise.

All sketches and drawings should be neat and tidy, to scale and annotated.

Calculations should be set out clearly, with all working shown, as well as any assumptions made. You should use appropriate units at all times, consistent with the requirements of the assignment.

Instructions for this assignment

Ensure you read all the provided assessment information contained in this candidate pack.

You must work independently and not share your work with any other candidates in these supervised assessment sessions.

Your work will be kept secure during any supervised breaks that are taken. Internet access is not allowed.

You must complete all the tasks and present all evidence that is detailed in each task.

This candidate booklet contains:

- An assignment brief
- Task 1
- Task 2
- Task 3

Within each task you will find the following:

Conditions of assessment: This will tell you the duration and rules you must follow when completing a task.

What must be produced for marking: This describes the evidence you must submit when the task is completed. Be aware failure to submit any evidence requested can adversely affect your overall mark for the assessment

Additional evidence for this task: This describes other forms of evidence that will be collected by the assessor to support the marking of your performance. This will often include but not limited to photographic and video evidence.

Assignment brief

You are an employee of L & M Plasterers Ltd, a local plastering company and you have been commissioned by the homeowner to carry out internal and external renovation work to their post-1960s property. The brief includes both internal plastering work to the living room and hallway and external rendering work to the house façade. It also includes some repair work to an existing plastered wall in the kitchen.

The work has been agreed over four days (26 hrs) and the homeowner has provided the following information/specification requirements for the renovation work:

Internal plasterwork

- a) The homeowner has indicated the living room window wall is constantly affected by condensation. You will need to install a dry lining system to the masonry wall, to eliminate the problem.
- b) As part of the renovation of the living room, the homeowner has asked you to produce and fix a pre-cast cornice moulding to the newly renovated chimney wall
- c) As part of the ongoing renovation in the hallway, a pier return needs to be floated and finished with a pre-blended lightweight plaster ready for decoration.

(Dimensions for the internal plastering work is shown in Figures 1-3)

External rendering work

The homeowner has asked you to present a plan and produce a sample of three different colour render finishes (one plain and two different textured finishes) complete with beads, to one of the building outside walls, to enable them to make a decision on the final render finish they require for the entire external property.

(Dimensions for external rendering work is shown in Figure 4)

Repair work

As part of the refurbishment of the homeowner's kitchen an electrician has installed a new double socket in a chased wall that is in need of repair. You have been asked to repair the wall and make good for decoration.

(Dimensions for external rendering work is shown in Figure 5)

Figures for the assignment brief requirements:

Figure 1 – Window wall in Living room

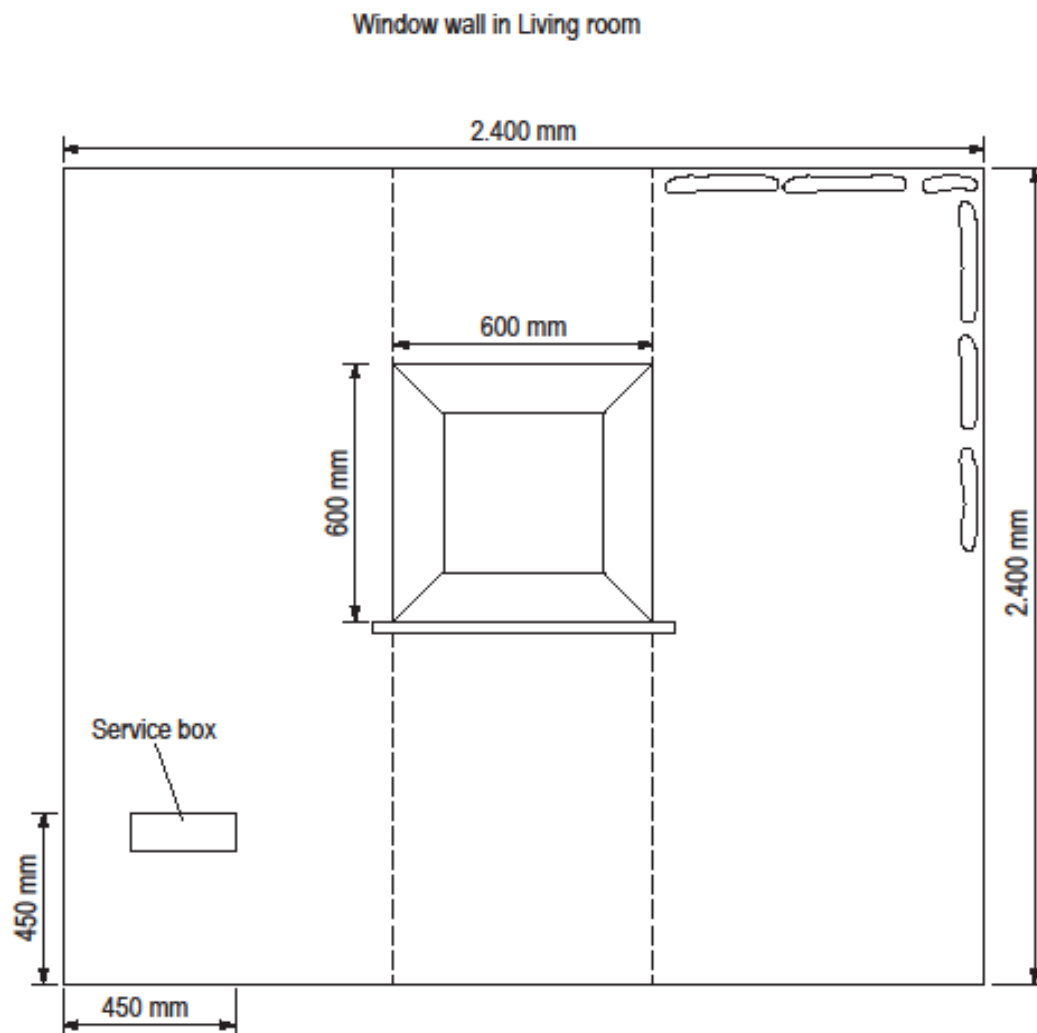

Figure 2 – Cornice in Living room

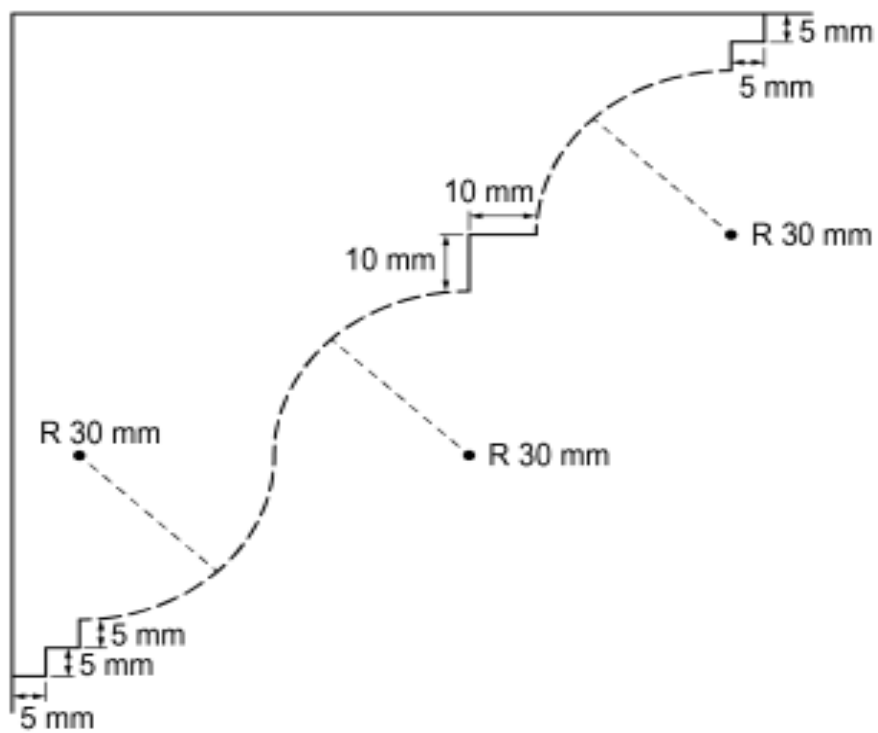
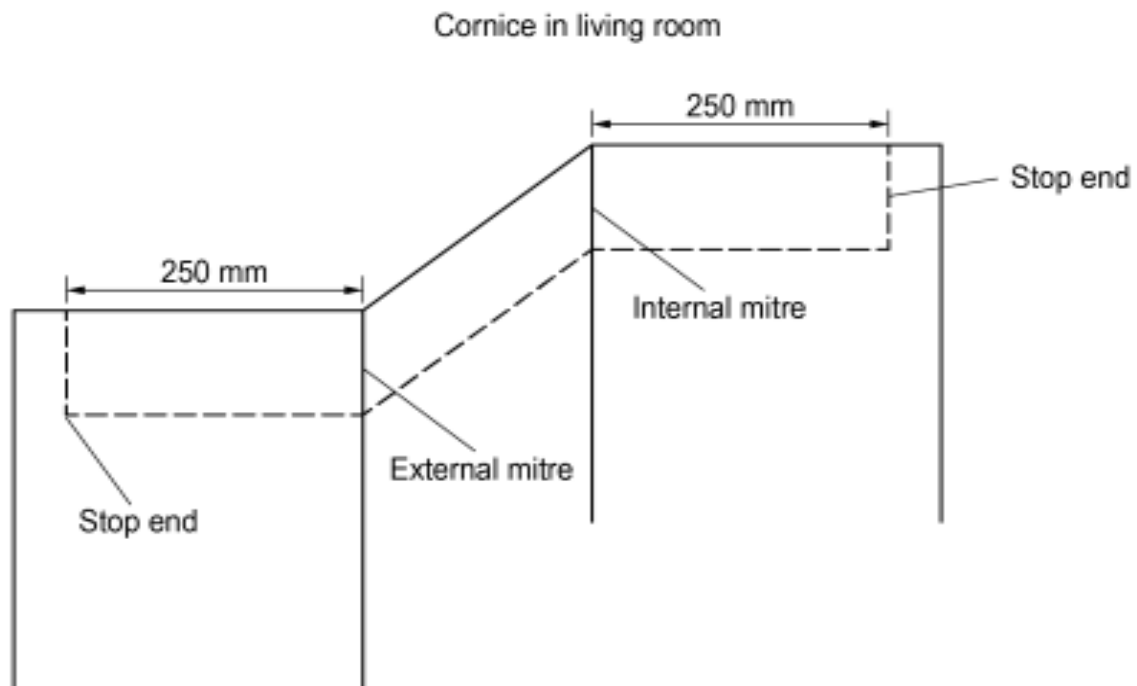

Figure 3 – Pier return in Hallway

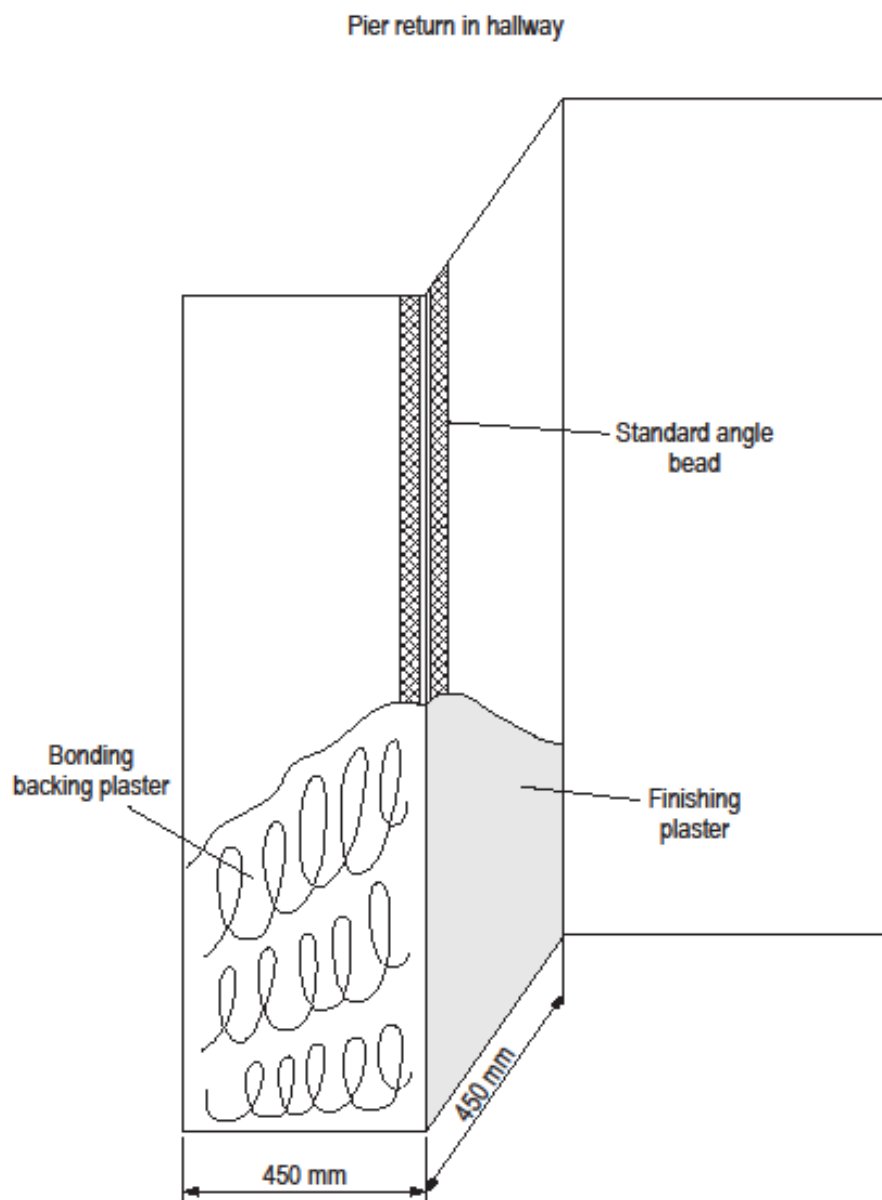

Figure 4 – External rendering work

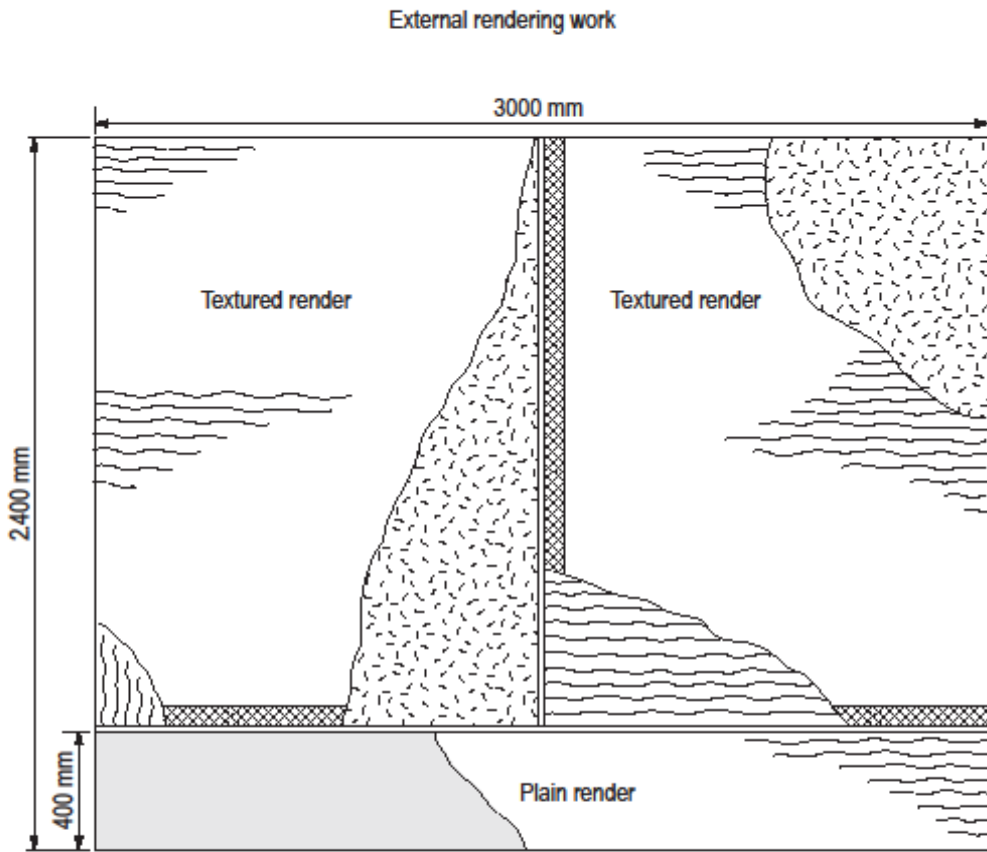
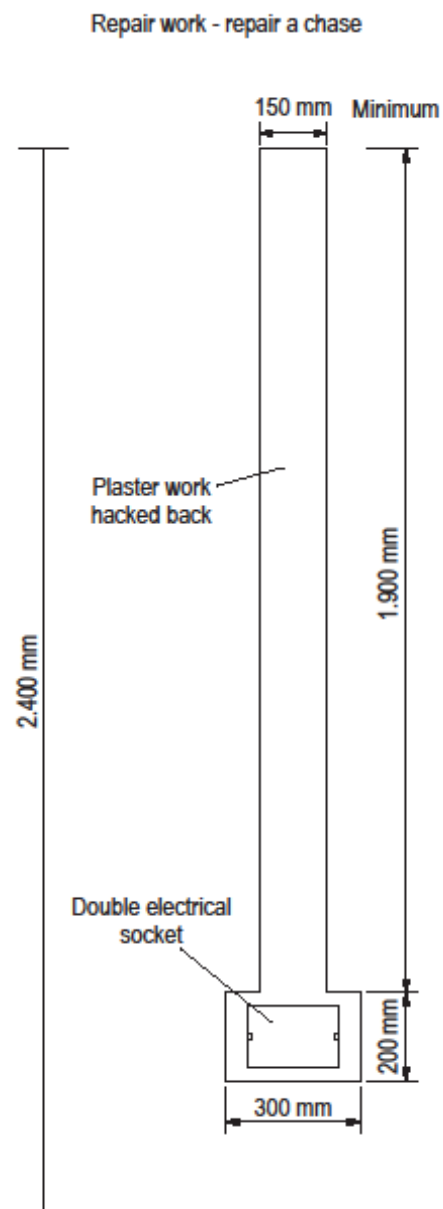

Figure 5 – Repair work – repair a chase



This assignment has a time allocation of 26 hours. You should plan your time to complete all the tasks.

Tasks

Task 1 – Prepare and plan backgrounds for installation

Your assessor will provide you with a specific working area, approximate maximum, and minimum dimensions as per the specification to ensure you meet the centre's resources. Your plan and drawing must be applicable to the area you are being assessed in and are to a suitable scale.

a) Plan for the internal plastering, external rendering, and repair work on the 1960s property

b) Present to the client the recommended materials to be used for the different internal plastering works and a specific colour through design for the external render

Conditions of assessment:

- The time allocated for this task is 6 hours
- You must carry out the task on your own, under controlled condition

What must be produced for marking:

- Measurements of the site location/work
- Method statement
- A risk assessment
- A materials list
- Plan and present to the client on the recommended materials to be used for the different internal plastering works and a specific colour through design for the external render using manufacturer samples/designs to support any recommendations.

You will be provided with templates to complete the method statement, risk assessment, and materials list.

The assessor will act as the homeowner during the presentation and record any feedback on the assessor feedback form

The presentation should **not** exceed 15 minutes

Additional evidence for this task:

- Assessor observation of measurements of the site location/work area to be confirmed by the assessor at the start of the planning activity.
- Assessor observation of the presentation of recommended materials.

Task 2 – Plaster and render installations

You will be provided with your plans from task 1 at the beginning of this assessment.

Internal plasterwork

- a) Install a dry lining system and finish to a window wall

Conditions of assessment:

- The time allocated for this task is 4.5 hours
- You must carry out the task on your own, under controlled conditions

What must be produced for marking:

- Completed window wall, dry line installation system with a plaster finish

Additional evidence for this task:

- Assessor observations
 - Completed dry line system installation with plaster finish - observations to include working with tolerances
- Assessor photographic/video evidence at various stages to show candidates progress against the task
 - Photographic evidence showing positioning of completed perimeter seals and dry wall adhesive dabs
 - Photographic evidence of plasterboard being installed to wall and window returns
 - Video evidence – showing a sequence of frames of the installation of the plasterboard to wall - to contain close ups frames showing detail of plumb, returns and tolerances
 - Photographic evidence of positioning of thin coat angle beads fixed to window returns
 - Video evidence with sequence of frames to show positioning of beads to all window returns, any adjustments made and final positioning
 - Photographic evidence of completed installation with plaster surface trowelled ready for decoration

- b) Cast and fix a cornice moulding to the chimney wall

A pre-prepared reverse mould will be provided to complete Task 2 b assessment

Conditions of assessment:

- The time allocated for this task is 4.5 hours
- You must carry out the task on your own, under controlled conditions

What must be produced for marking:

- Cornice moulding fixed in correct position and stopped-in in line with drawing dimensions

Additional evidence for this task:

- Assessor observations
 - Completed cornice moulding fixed in the correct and stopped-in in line with drawing dimensions - observations to include working with tolerances

- Assessor photographic/video evidence at various stages to show candidates progress against the task
 - Video evidence of pre -prepared reverse mould being prepared for casting. May show slight omissions in preparation.
 - Video evidence of cornice cast from reverse mould at beginning, middle and end stages
 - Photographic evidence of cornice moulding cut to dimensions
 - Photographic evidence of cornice moulding fit in position and stopped-in and made good

c) Apply float and finish to a pier return

Conditions of assessment:

- The time allocated for this task is 2.5 hours
- You must carry out the task on your own, under controlled conditions

What must be produced for marking:

- Completed pier return, correct position of standard angle bead, floated with a backing coat and finished and plastered ready for decoration

Additional evidence for this task:

- Assessor observations
 - Completed pier return, correct position of standard angle bead, floated with a backing coat and finished and plastered ready for decoration - observations to include working with tolerances
- Assessor photographic/video evidence at various stages to show candidates progress against the task
 - Video evidence of standard angle bead fixing and positioning, showing plumb lines
 - Video evidence of backing plaster surface consolidated, keyed, and cut back
 - Photographic evidence of completed pier return
 - Photographic evidence of completed plaster surface trowelled smooth ready for decoration

External rendering work

Apply and form plain and textured rendering finishes

Conditions of assessment:

- The time allocated for this task is 6.5 hours
- You must carry out the task on your own, under controlled conditions

What must be produced for marking:

- Three completed rendered surfaces (one plain and two different textured finishes) with a colour by design shown and separated with beads

Additional evidence for this task:

- Assessor observations
 - Three completed rendered surfaces (plain and textured) with a colour by design and separated with beads - observations to include working with tolerances
- Assessor photographic/video evidence at various stages to show candidates progress against the task
 - Video evidence of positioning of fixed beads for the 3 separate render surfaces
 - Video evidence of the application of the three surfaces for all three render finishes at the beginning, middle and upon completion
 - Photographic evidence of completion of all three render finishes

Task 3 - Repair to plaster surfaces

Repair a chase in the kitchen area after the installation of a new double socket

Conditions of assessment:

- The time allocated for this task is 2 hours
- You must carry out the task on your own, under controlled conditions

What must be produced for marking:

- A completed repaired chase ready for decoration

Additional evidence for this task:

- Assessor observations
 - A completed repaired chase ready for decoration - observations to include working with tolerances
- Assessor photographic/video evidence at various stages to show candidates progress against the task
 - Video evidence of backing coat being applied, ruled, keyed, and cut back
 - Photographic evidence of the repaired chase completed ready for decoration

End of Assessment

SAMPLE

Copyright in this document belongs to, and is used under licence from, the Institute for Apprenticeships and Technical Education, © 2020.

'T-LEVELS' is a registered trade mark of the Department for Education.

'T Level' is a registered trade mark of the Institute for Apprenticeships and Technical Education.

'Institute for Apprenticeships & Technical Education' and logo are registered trade marks of the Institute for Apprenticeships and Technical Education.